

Index File No. Z-25

CORNER RECORD (SEARCH)
(Ref. FSM 7151.4)

Tract or Survey No. _____ Cor. No. _____

T 4 S R. 33 E R.D. Ukiah County Umatilla

Merid. Will. N.F. Umatilla State Oregon

Priority 1

CORNER DIAGRAM

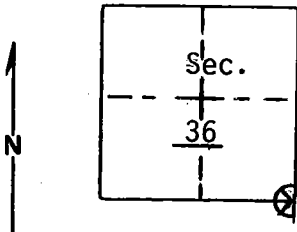

DESCRIBE CORNER MONUMENT FOUND

Material: Stone Mound Size: Mound 5' diam
Height above ground: 2'

DESCRIBE BEARING TREES OR OTHER OFFICIAL ACCESSORIES FOUND

Evidence of east-west fence through open glade. F.S. location poster on post where gate used to be 260' west of cor. It is dated 8/3/44. Poster says Sec. cor. 4 ch. east.

PHOTO IDENTIFICATION DATA

Photo No. _____
Filed At. _____
Object Ident. _____
Ident. By _____
Signature

PLANE COORDINATE POSITION DATA

State _____ Zone _____
X _____
Y _____
Estab. By _____
Agency

DESCRIBE CORNER LOCATION RELATIVE TO NEAR-BY FEATURES, ALSO HOW TO REACH CORNER

Cor. was found by pacing north from found corner to the south.
(950 feet, Approx.)

Signature

B. Moore

Title

Division

Headquarters

Date

4-77

7100-52-(3/68)

CORNER RECORD (PERPETUATION)

GPO 902-673

MONUMENT: DESCRIBE NEW MONUMENT SET, OR WORK DONE TO PRESERVE EXISTING MONUMENT

9

ACCESSORIES : DESCRIBE NEW BT'S WITNESS OBJECTS ETC. ESTABLISHED, OR WORK DONE TO PRESERVE EXISTING EVIDENCE

10

Work Done By _____ Title _____ Date _____ State Registration No. or Agency _____

Certified Cor. Record Prepared ? Yes No Filed At: _____ Date _____

11

REMARKS

12

Index. File No. T. R. M. Tract or Surv. No. Cor. _____

13

USDA-FOREST SERVICE

Index
File No. A-25

CORNER RECORD (SEARCH)

(Ref. FSM 7151.4)

Tract or
Survey No. _____

Cor.
No. Township

T 4 & 5S R. 33E

R.D. Ukiah County Umatilla

Merid. Willamette

N.F. Umatilla State Oregon

CORNER DIAGRAM

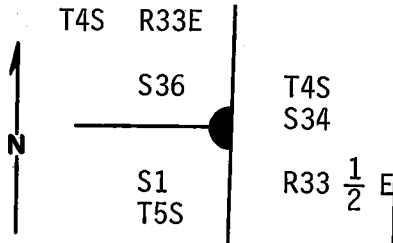

DESCRIBE CORNER MONUMENT FOUND

At assumed corner location found mound of stone one foot high and 6 ft. wide with dirt covering most of stones. Found traces of rotted wood about 2 ft. below top of mound of stone, possible remains of original post. Found remains of old East-West fence.

DESCRIBE BEARING TREES OR OTHER OFFICIAL ACCESSORIES FOUND

None set.

PHOTO IDENTIFICATION DATA

Photo No. _____

Filed At. _____

Object Ident. _____

Ident. By _____

Signature

PLANE COORDINATE POSITION DATA

State _____ Zone _____

X _____

Y _____

Estab. By _____

Agency

Signature

Howard L. Smith

Title

Division
ORLS

Headquarters
1294

Date
9/77

7100-52-(3/68)

CORNER RECORD (PERPETUATION)

MONUMENT: DESCRIBE NEW MONUMENT SET, OR WORK DONE TO PRESERVE EXISTING MONUMENT

T4S R33E

As evidence in the vicinity of corner agrees with GLO original record,
 in the center of stone mound where traces of rotted wood was found
 set 2½"x30" galvanized pipe with brass cap stamped:
 Set pipe 26" in ground with mound of stone to cap.

S36	T4S
S1	S34
T5S	R33½ E
1980	
OR PLS 1294	

ACCESSORIES : DESCRIBE NEW BT'S WITNESS OBJECTS ETC. ESTABLISHED, OR WORK DONE TO PRESERVE EXISTING EVIDENCE

A P. Pine 24" in dia. bears S39°W, 402.7 ft. scribed T5S R33E S1 BT. No trees within distance for Northwest BT. Due to wetness of glade, it was felt impractical to set bearing object. Attached 54-3 and 54-4 signs to BT. Attached brass washer stamped LS 1294 to foot blaze of BT. Painted blazes and 6" band around BT. red. Attached 54-4 sign to metal post 6 ft. south of corner.

10

Work Done By: R.C. Orton Title: Party Chief Date: 5/28/80 State Registration No. _____
 or Agency _____

Certified Cor. Record Prepared ? Yes No Filed At: _____ Date _____ 11

REMARKS

Witnesses: R. Orton
 G. Lester
 L. Huntsman