

Index
File No. 2-17

CORNER RECORD (SEARCH)

(Ref. FSM 7151.4)

Tract or Survey No. _____ Cor. No. 1775

T 3 S R. 33 E

R.D. LA GRANDE County UNION & UMATILLA

Merid. WILLAMETTE

N.F. WALLOWA-WHITMAN State OREGON

CORNER DIAGRAM

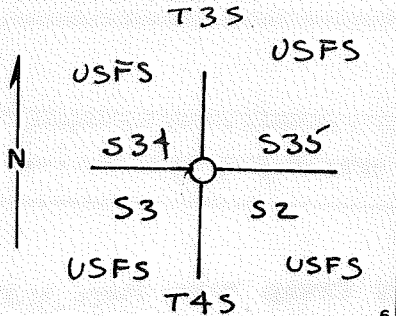

DESCRIBE CORNER MONUMENT FOUND

NONE

DESCRIBE BEARING TREES OR OTHER OFFICIAL ACCESSORIES FOUND

3 1/2" P.P. STUMP 6' HIGH, BEARS S21°E, 89.8 FT. TO FACE OF BLAZE, B&S VISIBLE (45R 33E S2)

DESCRIBE CORNER LOCATION RELATIVE TO NEAR-BY FEATURES, ALSO HOW TO REACH CORNER FROM INTERSECTION OF ~~2110-220~~ AND 2110-049 SOUTHWEST IS VISIBLE 200 FT. NORTHEAST.

PHOTO IDENTIFICATION DATA

Photo No. _____
Filed At. _____
Object Ident. _____
Ident. By _____
Signature

PLANE COORDINATE POSITION DATA

State _____ Zone _____
X _____
Y _____
Estab. By _____
Agency

Signature _____ Title _____ Division _____ Headquarters _____ Date _____

[Signature] S 1848

FS-7100-52 (3/68)

5-22-84

CORNER RECORD (PERPETUATION)

MONUMENT: DESCRIBE NEW MONUMENT SET, OR WORK DONE TO PRESERVE EXISTING MONUMENT

SET 2 1/2" X 30" ALUMINUM CAPPED ALUMINUM PIPE RISING 14"
IN MOUND OF STONE & EARTH, MARKED:

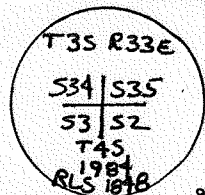

ACCESSORIES: DESCRIBE NEW BT'S WITNESS OBJECTS ETC. ESTABLISHED, OR WORK DONE TO PRESERVE EXISTING EVIDENCE

5" WEST. LARCH BEARS N66 1/4° W, 60.6 FT. B&S "X" BT
1 1/2" POND. PINE BEARS N47° E, 112.8 FT. B&S T3S R33E S35 BT
5" WEST. LARCH BEARS S31° E, 157.9 FT. B&S "X" BT
15 1/2" WEST. LARCH BEARS S57° W, 113.5 FT. B&S T4S R33E S3 BT

Work Done By B.A. SUTTON Title SURVEYOR Date 5-22-84 State Registration No. LS 1848
or Agency

Certified Cor. Record Prepared? Yes No Filed At: UNION CO. SURVEYOR'S OFFICE Date

REMARKS

Index File No. Z-17 T. 3S R. 33E W.M.

Tract or Surv. No.

Cor. 1775

USDA-FOREST SERVICE

Index 2File No. 17

CORNER RECORD (SEARCH)

(Ref. FSM 7151.4)

Tract or

Survey No. _____

Cor.

No. _____

T 3S R. 33ER.D. LaGrande County UmatillaMerid. WillametteN.F. Wallowa-Whitman State Oregon

CORNER DIAGRAM

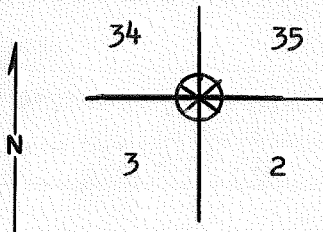

DESCRIBE CORNER MONUMENT FOUND

None possitive, scattered mound of stones.

DESCRIBE BEARING TREES OR OTHER OFFICIAL ACCESSORIES FOUND

Section 2- 30" PPstump in fair condition scrib visible.

PHOTO IDENTIFICATION DATA

Photo No. 777-121Filed At. LaGrandeObject Ident. Corner

Ident. By _____

Signature

DESCRIBE CORNER LOCATION RELATIVE TO NEAR-BY FEATURES, ALSO HOW TO REACH CORNER

PLANE COORDINATE POSITION DATA

State _____ Zone _____

X _____

Y _____

Estob. By _____

Agency

Signature

Title

Division

Headquarters

Date

7100-52-(3,68)

David L. Dahlstrom *CFE**LaGrande**6-15-83*

5

CORNER RECORD (PERPETUATION)

MONUMENT: DESCRIBE NEW MONUMENT SET, OR WORK DONE TO PRESERVE EXISTING MONUMENT

ACCESSORIES DESCRIBE NEW BT'S WITNESS OBJECTS ETC. ESTABLISHED, OR WORK DONE TO PRESERVE EXISTING EVIDENCE

Work Done By _____ Title _____ Date _____ State Registration No. _____
or Agency _____

Certified Cor. Record Prepared? Yes No Filed At: _____ Date _____

REMARKS

Index File No. T. R. M. Tract or Surv. No. Cor.

Index
File No. Z-17
T 3S R. 33 E
Merid. WILLAMETTE

CORNER RECORD (SEARCH)

(Ref. FSM 7151.4)

R.D. LA GRANDE County UNION Tract or Survey No. _____
N.F. WALLOWA WHITMAN State OREGON Union - Yamhill Co. line
Cor. S.E. COR.
No. SEC. 34

CORNER DIAGRAM

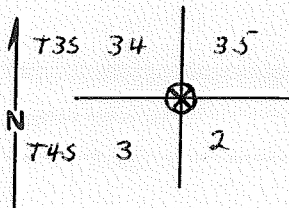

DESCRIBE CORNER MONUMENT FOUND

DESCRIBE BEARING TREES OR OTHER OFFICIAL ACCESSORIES FOUND

1 live pine B.T. 30".
old tag, hung yellow ribbon.

PHOTO IDENTIFICATION DATA

Photo No. ENW 1-323
Filed At. _____
Object Ident. _____
Ident. By _____
Signature

DESCRIBE CORNER LOCATION RELATIVE TO NEAR-BY FEATURES, ALSO HOW TO REACH CORNER

Located 200 yds north of end of spur road on north side of dipping vat creek.

PLANE COORDINATE POSITION DATA

State _____ Zone _____
X _____
Y _____
Estab. By _____
Agency

Signature
D. WYLAND

Title

Division

Headquarters

Date
5/73

7100-52-(3/68)

5

CORNER RECORD (PERPETUATION)

MONUMENT : DESCRIBE NEW MONUMENT SET, OR WORK DONE TO PRESERVE EXISTING MONUMENT

ACCESSORIES : DESCRIBE NEW BT'S WITNESS OBJECTS ETC. ESTABLISHED, OR WORK DONE TO PRESERVE EXISTING EVIDENCE

Work Done By _____ Title _____ Date _____ State Registration No. _____
or Agency _____

Certified Cor. Record Prepared ? Yes No Filed At: _____ Date _____

REMARKS

Index File No. T. R. M. Tract or Surv. No. Cor.

USDA-FOREST SERVICE

Index File No. Z-17

CORNER RECORD (SEARCH)

(Ref. FSM 7151.4)

Tract or Survey No. _____

Cor. No. _____

T 35 R. 33E

R.D. N.F. JOHN DAY

County UMATILLA/UNION

Merid. WILL

N.F. UMATILLA

State OREGON

CORNER DIAGRAM

DESCRIBE CORNER MONUMENT FOUND

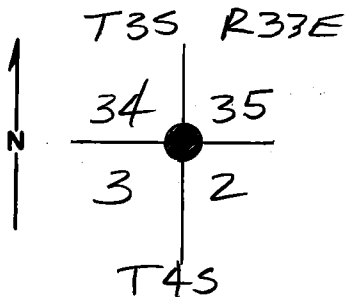

None

DESCRIBE BEARING TREES OR OTHER OFFICIAL ACCESSORIES FOUND

31" Pond Pine stump S21°E, 89.8ft
scribes visible.

PHOTO IDENTIFICATION DATA

Photo No. _____

Filed At. _____

Object Ident. _____

Ident. By _____

Signature

PLANE COORDINATE POSITION DATA

State _____ Zone _____

X _____

Y _____

Estab. By _____

Agency

Signature

Title

Division

Headquarters

Date

7100-52-(3/68)

CORNER RECORD (PERPETUATION)

MONUMENT: DESCRIBE NEW MONUMENT SET, OR WORK DONE TO PRESERVE EXISTING MONUMENT

Aluminum pipe & Cap

ACCESSORIES: DESCRIBE NEW BT'S WITNESS OBJECTS ETC. ESTABLISHED, OR WORK DONE TO PRESERVE EXISTING EVIDENCE

5" W. Larch N 66° 15' W, 60.6 FT
11" Pond Pine N 47° E, 112.8 FT
5' W. Larch S 31° E, 157.9 FT
16" W. Larch S 57° W, 113.5 FT

Work Done By SUTTON Title LS Date 5/84 State Registration No. 1848
or Agency

Certified Cor. Record Prepared? Yes No Filed At: UMATILLA & UNION Co.'s Date 1984

REMARKS

Index File No. Z-17 T. 35 R. 33E M. Tract or Surv. No. Cor.