

CERTIFIED RECORD OF LAND CORNER MONUMENTATION

N-15

History of original corner establishment:

Corner originally established by George S. Pershin, U.S. Deputy Surveyor, under Contract No. 390, dated May 12, 1881. Surveyor General records state: Set basalt stone 18x8x7 on level for $\frac{1}{4}$ Sec. corner. A pine 26 in. di. brs. N4⁰W, 44 lks. dist. A pine 26 in. di. brs. S16⁰E, 99 lks. dist.

Corner remonumented by Craig L. Wanless, BLM Cadastral Surveyor under instructions dated July 18, 1977. His record states: The $\frac{1}{4}$ sec. cor. of sec. 15 & 22, determined at record bearing and distance from the remains of the original bearing trees: A sawed and decayed pine stump, size indeterminate, bears N4⁰W, 44 lks. dist., with scribe marks BT visible on open blaze. A pine 15 ins. diam. bears S16⁰E, 99 lks. dist. with scribe marks $\frac{1}{4}$ S visible on partially healed blaze. At the corner point... Set an iron post, 28 ins. long, 2 $\frac{1}{2}$ ins. diam. 24 ins. in ground, with brass cap mkd. (as shown in corner diagram) from which a new bearing tree... A lodgepole pine 15 ins. diam. bears N51⁰E, 57 lks. dist. mkd. $\frac{1}{4}$ S15 BT.

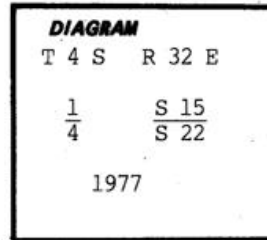

Description of corner evidence found:

Found 2 $\frac{1}{2}$ " iron pipe with 3 $\frac{1}{4}$ " brass cap (as shown in corner diagram) in mound of stone.

A 17" ponderosa pine brs N50 $\frac{1}{2}$ ⁰E, 37.5' with scribing visible.

Badly rotted ponderosa pine stump size indeterminate, no scribing visible brs N6 $\frac{1}{4}$ ⁰W, 29.8'.

A 12" ponderosa pine snag brs S17 $\frac{1}{2}$ ⁰E, 65.2' with scribing visible.

Description of monument and accessories established to perpetuate the original location of this corner:

Set steel fence post next to corner with sign 54-9 attached.

New bearing trees established:

A 14" ponderosa pine brs S8 $\frac{3}{4}$ ⁰E, 43.9' scribed 1/4S22 BT.

A 13" ponderosa pine brs S63⁰W, 15.5' scribed 1/4S22 BT

A 12" ponderosa pine brs N40 $\frac{1}{4}$ ⁰W, 32.1' scribed 1/4S15 BT.

New BT's have a brass washer stamped PLS 1106 nailed to face of blaze. Attached sign 54-3 & 54-9, painted face of blaze & a 6" red band around each BT.

Compass declination 18⁰ East.

I hereby certify that the above corner monument was properly maintained to U.S.F.S. standards by me on June 03, 1992.

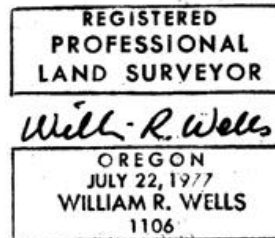

Office of... County Surveyor County of... Umatilla
Oregon
 State of..... I hereby certify that the within instrument was filed in this office
 for record on the..... day of....., 19.....
 by
 (COUNTY OFFICIAL) (DEPUTY)

RECEIVED BY

Umatilla County Surveyor

Date 7-92

Rec'd By [Signature]

No. 92-80-B

Form R6-7100-57 (9/71)

☆ GPO-798-276

N-15