

CERTIFIED RECORD OF LAND CORNER MONUMENTATION

V - 7  
DIAGRAM

History of original corner establishment:

The original corner was established by George S. Pershin on October 28, 1880, under GLO contract No. 373, as follows:

T4S R31E  
1/4 S29  
S32  
PLS 1636  
1998

Set a basalt stone 18" x 10" x 8" in a sag in a point of timber for the 1/4 section corner, from which:

- A 16" pine bears N52°W, 60 links (39.60 feet).
- A 28" pine bears S63°E, 22 links (14.52 feet).

Corner evidence recovered:

Found the original corner stone loosely set in a mound of stones. The corner stone is 18" x 13" x 10" and has visible chisel marks. From the stone:

- A 33" sawn Ponderosa Pine stump 4 foot high with scribes "4S BT" visible on previously opened double blazes, bears S63°E, 14.5 feet.
- A 20" down and decayed Ponderosa Pine has scribes "1/4S BT" visible on double blazes. The root hole bears N52°W, 39.6 feet.

Monument and accessories established to perpetuate the original location of this corner:

In place of the original corner stone, I set a 1" x 30" iron pipe 25" into the ground. A 2 1/2" brass cap attached to the pipe is marked as shown in the diagram above. I bury the corner stone along the northeast side of the pipe and build a mound of stones around the pipe to the cap, from which:

- A 15" Ponderosa Pine, scribed "1/4 S29 BT", bears N19°30"E, 22.4 feet.
- A 10" Ponderosa Pine, scribed "1/4 S32 BT", bears S28°E, 42.2 feet.
- A 22" Ponderosa Pine, scribed "1/4 S32 BT", bears S49°W, 47.7 feet. This bearing tree is on the south edge of a small draw.
- A 17" Ponderosa Pine, scribed "1/4 S29 BT", bears N42°W, 54.8 feet.

The new bearing trees have a 3/4" brass washer, marked "PLS 1636", nailed flush to the scribed "B", and a "Witness Post" sign nailed to the back of the tree. The original bearing trees and the new bearing trees have a "Bearing Object" sign nailed above the blazes.

I hereby certify the above corner point was perpetuated as hereon described on July 3, 1998, Magnetic declination: 18°E. This corner is about 45 feet north of a small draw flowing west to east.

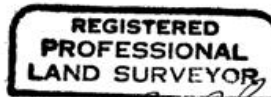

*Dennis L. Gaylord*

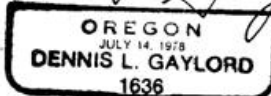

Renews June 30, 1999

Recorded at the office of County Surveyor, County of Umatilla, State of Oregon, on \_\_\_\_\_, 1998.

RECEIVED BY

Umatilla County Surveyor

Date 8-98

Rec'd By JK

No. 98-160-R