

SECTION 23 & 26 TOWNSHIP 4 S RANGE 31 E UMATILLA COUNTY

CORNER DESIGNATION

23
— • —
26
1/4

TYPE OF REPORT

- CONDITION ONLY
- NOT FOUND
- RENEWED
- UNRECORDED
- SURVEYED IN
- REFERENCED OUT

HISTORY OF ORIGINAL CORNER AND/OR PREVIOUS RENEWALS:

CONTRACT NO. 373 BY GEORGE S. PERSHIN DATED SEPTEMBER 17, 1880, ESTABLISHED:
A 28" PINE FOR 1/4 SECTION CORNER ON LEVEL
A PINE 10 INS. DIAM. BRS. N. 8° W. 29 LKS. DIST.
A PINE 8 INS. DIAM. BRS. S. 40° W. 42 LKS. DIST.

DESCRIPTION OF CORNER EVIDENCE FOUND:

IN AUGUST 2014 A 28" +/- TREE WAS FOUND DEAD AND LAYING DOWN WITH 4" YELLOW BLM TAG MARKING AS A 1/4 CORNER OF SECTIONS 23 & 26. NONE OF THE ORIGINAL BEARING TREES WERE FOUND.

MONUMENT DETAIL

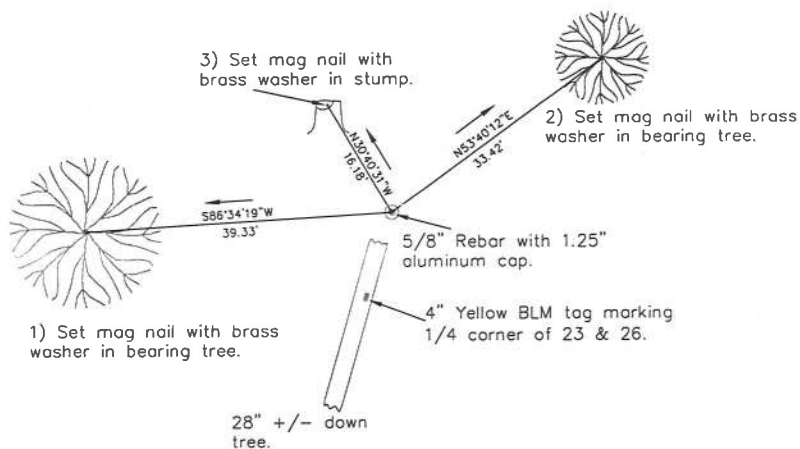
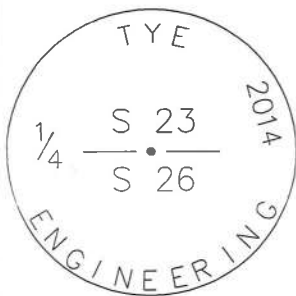

PERSONNEL PRESENT:
DIRK DURYEE, PLS

DESCRIPTION OF NEW MONUMENT SET:

A 5/8" REBAR W/ 1.25" ALUMINUM CAP (WITH MARKINGS AS SHOWN ABOVE) WAS SET IN THE CAVITY LEFT IN SOIL AFTER ORIGINAL TREE HAD FALLEN MARKING THE 1/4 CORNER OF 23 & 26.

BEARING TREES WERE SET WITH MAG NAILS AND BRASS WASHERS MARKED "TYE ENGINEERING"

- 1) 10" PINE TREE, BEARS S 86°34'19" W 39.33'
- 2) 6" PINE TREE, BEARS N 53° 40'12" E 33.42'

MAG NAIL WITH BRASS WASHER MARKER "TYE ENGINEERING" WAS SET IN STUMP
3) BEARS N 30°40'31" W 16.18'

RECEIVED BY

Umatilla County Surveyor

Date: 11/25/2014

Rec'd By: G. Hensley

No.: 14-1416-R

FIRM/AGENCY NAME:

ADDRESS:

TYE ENGINEERING & SURVEYING, INC.
725 NW HILL STREET
BEND, OREGON 97701

SURVEYOR'S SEAL



RENEWS: 12/31/2015