

USDA-FOREST SERVICE

Index File No. L-25

CORNER RECORD (SEARCH)

(Ref. FSM 7151.4)

Tract or Survey No. _____

Cor. No. _____

T 4S R. 30 & 31E

R.D. Ukiah

County Umatilla

Merid. Willamette

N.F. Umatilla

State Oregon

CORNER DIAGRAM

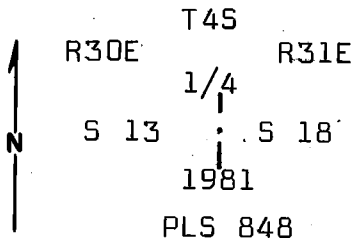

DESCRIBE CORNER MONUMENT FOUND

Found old stone mound alongside a rock crib; stone of record size (17x10x8) in center of mound. No marks visible.

DESCRIBE BEARING TREES OR OTHER OFFICIAL ACCESSORIES FOUND

No bearing trees originally established. Since the old mound is not a part of the fence and is harmonious with adjacent found corners, the center of the mound is accepted as the 1/4 corner position.

PHOTO IDENTIFICATION DATA

Photo No. _____
 Filed At. _____
 Object Ident. _____
 Ident. By _____
 Signature _____

DESCRIBE CORNER LOCATION RELATIVE TO NEAR-BY FEATURES, ALSO HOW TO REACH CORNER

Corner is in open pine timber on gentle SE slope, N-S fence approx. 3 ft. West and an E-W primitive road approx. 200 ft. North.

PLANE COORDINATE POSITION DATA

State _____ Zone _____
 X _____
 Y _____
 Estab. By _____
 Agency _____

Signature _____

Title

PLS 848

Division

Headquarters

Mt. Vernon, OR

Date

8/6/81

7100-52-(3/68)

CORNER RECORD (PERPETUATION)

MONUMENT DESCRIBE NEW MONUMENT SET, OR WORK DONE TO PRESERVE EXISTING MONUMENT

Set 3"x30" galv. iron pipe with 3" brass cap stamped as shown on the diagram. Set 16 inches in the ground and raised a mound of stone around the pipe.

From which:

ACCESSORIES DESCRIBE NEW BT'S WITNESS OBJECTS ETC. ESTABLISHED, OR WORK DONE TO PRESERVE EXISTING EVIDENCE

A pine 10 inches dia. bears N37°W, 43.5 ft. scribed 1/4 S 13 BT.
A pine 20 inches dia. bears N1°E, 16.3 ft. scribed 1/4 S 18 BT.
Set steel posts with warning and boundary signs 5 ft. North and 5 ft. South from corner
Nailed bearing tree signs and brass washers stamped PLS 848 to each tree.
Painted red band around each tree.

Work Done By D.M. Ferguson Title Surveyor Date 8/6/81 State Registration No. OR PLS 848
or Agency

Certified ~~REGISTERED~~ ~~RECORDED~~ Prepared? Yes No Filed At: Umatilla Co. Surveyor Date

PROFESSIONAL
LAND SURVEYOR

REMARKS

Witnesses to above corner:
D. Mitchell Ferguson
Mike Woodward

OREGON
JULY 12, 1968
DOUGLAS M. FERGUSON
848

Index
File No. L-25

CORNER RECORD (SEARCH)

(Ref. FSM 7151.4)

Tract or Survey No. 4-142

Cor. No. L-25

T 4S R. 30E

R.D. Ukiah County Umatilla

Merid. Willamette

N.F. Umatilla State Oregon

CORNER DIAGRAM

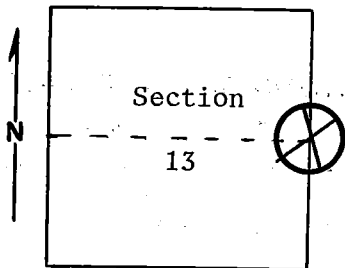

DESCRIBE CORNER MONUMENT FOUND

Material: Nothing reliable.

DESCRIBE BEARING TREES OR OTHER OFFICIAL ACCESSORIES FOUND

There is a north-south fence line. Approximately 100 feet south of where an east-west primitive road crosses this fence is a rock cairn with fence wire around it. It sets on the edge of an older low flat circle of stones. It appears to be in approximately the proper $\frac{1}{4}$ corner location, but there is no reliable evidence. There were no original B.T.'s.

DESCRIBE CORNER LOCATION RELATIVE TO NEAR-BY FEATURES, ALSO HOW TO REACH CORNER

PHOTO IDENTIFICATION DATA

Photo No. _____
Filed At. _____
Object Ident. _____
Ident. By _____
Signature

PLANE COORDINATE POSITION DATA

State _____ Zone _____
X _____
Y _____
Estab. By _____
Agency

Signature
T. Hollamon

Title
Engineering Technician

Division
S. O.

Headquarters
Date
May 31, 1974

7100-52-(3/68)

2

CORNER RECORD (PERPETUATION)

MONUMENT: DESCRIBE NEW MONUMENT SET, OR WORK DONE TO PRESERVE EXISTING MONUMENT

9

ACCESSORIES : DESCRIBE NEW BT'S WITNESS OBJECTS ETC. ESTABLISHED, OR WORK DONE TO PRESERVE EXISTING EVIDENCE

10

Work Done By _____ Title _____ Date _____ State Registration No. _____
or Agency _____

Certified Cor. Record Prepared ? Yes No Filed At: _____ Date _____ 11

REMARKS

12

Index File No. _____ T. _____ R. _____ M. _____ Tract or Surv. No. _____ Cor. _____ 13