

Index File No. E-11

CORNER RECORD (SEARCH)

(Ref. FSM 7151.4)

Tract or Survey No. _____ Cor. No. _____

T 4 S. R. 31 E. R.D. Ukiah County Umatilla

Merid. Willamette N.F. Umatilla State Oregon

CORNER DIAGRAM

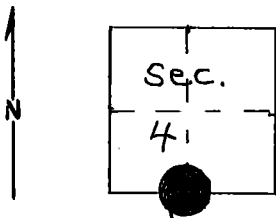

DESCRIBE CORNER MONUMENT FOUND

Material: Stone Mound.
 Markings: None visible. Steel post with paddle with 1/4 marked on it sets in center of mound. 2 feet South of East-West fence.

Monumented By BLM, 1978

DESCRIBE BEARING TREES OR OTHER OFFICIAL ACCESSORIES FOUND

A 14" ponderosa pine bears N 40° W. 46 feet. It has State Park Location Poster on it dated 9-16-75. Tree is scribed S 1/4, S 4, B.T. A 13" ponderosa pine bears S85° E. approximately 75'. It is scribed N 1/4, S 9, B.T.
 Stump hole of original B.T. bears N 42° E, 160 feet.

PHOTO IDENTIFICATION DATA

Photo No. _____
 Filed At. _____
 Object Ident. _____
 Ident. By _____
Signature

PLANE COORDINATE POSITION DATA

State _____ Zone _____
 X _____
 Y _____
 Estab. By _____
Agency

DESCRIBE CORNER LOCATION RELATIVE TO NEAR-BY FEATURES, ALSO HOW TO REACH CORNER

1/4 corner location is about 2 feet South of East-West fence and about 500 feet West of Junction of Highway 395 and Albee Road.

Signature W. Moore

Title Engr. Tech.

Division _____ Headquarters _____

Date 4-27-76

7100-52-(3/68)

CORNER RECORD (PERPETUATION)

GPO 902-673

MONUMENT: DESCRIBE NEW MONUMENT SET, OR WORK DONE TO PRESERVE EXISTING MONUMENT

9

ACCESSORIES : DESCRIBE NEW BT'S WITNESS OBJECTS ETC. ESTABLISHED, OR WORK DONE TO PRESERVE EXISTING EVIDENCE

10

Work Done By _____ Title _____ Date _____ State Registration No. or Agency _____

Certified Cor. Record Prepared ? Yes No Filed At: _____ Date _____

REMARKS

12

Index File No. T. R. M. Tract or Surv. No. Cor. 13