

U. S. Department of Agriculture
FOREST SERVICE

Umatilla NATIONAL FOREST

CORNERS OF THE PUBLIC SURVEY

T. 4S R. 31E Will Mer.

1/4 Corner common to Sections
4, 5, -, and -

Corner consists of a Stone () in place
State condition Good, Markings dim

Dimensions above ground 8 x 8 x 15 inches.

Sketch grooves, letters, figures, or notches, on proper face or edge.

| | | | |
|------------|---|---|---|
| <u>1/4</u> | | | |
| N | W | S | E |

| | | | |
|----|----|----|----|
| | | | |
| NW | SW | SE | NE |

Mound of None is located

Pits are located None

Sketch markings of Bearing Trees (or Rocks) in proper box and fill blanks below, giving bearings from Corner to Trees and Distances in Links.

| | | | |
|-------------------|-------------|--|--|
| <u>1/4S</u> | <u>1/4S</u> | | |
| <u>Grown over</u> | | | |

| | | |
|----------|--------------|--------------|
| Species | <u>PP</u> | <u>PP</u> |
| Diameter | <u>24"</u> | <u>15"</u> |
| Bearing | <u>N46°E</u> | <u>S89°W</u> |
| Distance | <u>36'</u> | <u>39'</u> |

Do you believe this to be a genuine Land Office Corner? Yes
If not, why? _____

A. J. Warren
(Signature)

(Signature)

For code TM
(Title)

8/11/53
(Date)

T. _____ R. _____ Mer.

(Make sketch of topography near Corner and show section line markers thus "X")

| | | | |
|------|--|------|--|
| | | | |
| Sec. | | Sec. | |
| | | | |
| Sec. | | Sec. | |
| | | | |

Metal Location Poster is on a _____
tree _____ inches diameter, on the _____
side of _____ from which
this Corner bears _____ (Bearing) _____ (Distance) Chains.

Section line marker between Secs. _____ and _____ is on
a _____ (Tree, post, etc.) _____ (Name of road, trail, etc.)
on the _____

located _____ chains E., W., N., S., from Sec. Cor.; $\frac{1}{4}$ Cor.; Witness Cor.
(Cross out nonapplicable)

Give any further facts needed to find Corner again:

Index File No. C-9
 T 4 S. R. 31 E.
 Merid. Willamette

CORNER RECORD (SEARCH)

(Ref. FSM 7151.4)

R.D. Ukiah County Umatilla Tract or Survey No. _____ Cor. No. _____
 N.F. Umatilla State Oregon

CORNER DIAGRAM

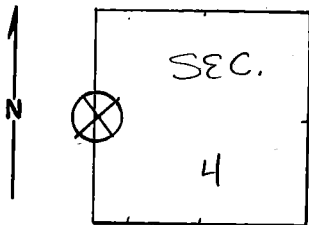

DESCRIBE CORNER MONUMENT FOUND

None

DESCRIBE BEARING TREES OR OTHER OFFICIAL ACCESSORIES FOUND

36" ponderosa pine blazed on south face, scribing visible. Forest Service location poster dated 8/25/53. Also attention poster. S 72° W from other B.T. approximately 65' distance is 20" ponderosa pine blazed on east face, scribed ¼ south with Forest Service attention poster above blaze. Scribing looks authentic but no bearing trees mentioned in G.L.O. notes.

DESCRIBE CORNER LOCATION RELATIVE TO NEAR-BY FEATURES, ALSO HOW TO REACH CORNER

Corner is in shallow draw on east facing slope. (Area is within recently surveyed Oregon State Park Boundary. ~~Bar~~ ^{Reinforcing} fencing ^{Rod,} 5/8", markers with cast cap)

PHOTO IDENTIFICATION DATA

Photo No. _____
 Filed At. _____
 Object Ident. _____
 Ident. By _____
Signature

PLANE COORDINATE POSITION DATA

State _____ Zone _____
 X _____
 Y _____
 Estab. By _____
Agency

Signature W Moore Title Engr, Tech, Division _____ Headquarters _____ Date 4/76 7100-52-(3/68)

CORNER RECORD (PERPETUATION)

MONUMENT: DESCRIBE NEW MONUMENT SET, OR WORK DONE TO PRESERVE EXISTING MONUMENT

ACCESSORIES : DESCRIBE NEW BT'S WITNESS OBJECTS ETC. ESTABLISHED, OR WORK DONE TO PRESERVE EXISTING EVIDENCE

Work Done By _____ Title _____ Date _____ State Registration No. or Agency _____

Certified Cor. Record Prepared ? Yes No Filed At: _____ Date _____

REMARKS

Index File No. T. R. M. Tract or Surv. No. Cor.