

Index File No. V-25 CORNER RECORD (SEARCH) (Ref. FSM 7151.4) Tract or Survey No. _____ Cor. No. _____
 T 4 S. R. 30 E. R.D. Ukiah County Umatilla
 Merid. Willamette N.F. Umatilla State Oregon

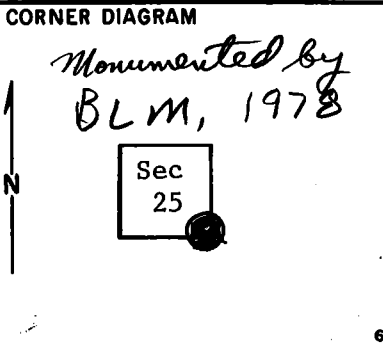

DESCRIBE CORNER MONUMENT FOUND

2"x2" square stake in stoned mound. Mound 2' diam., 1' deep, 1 ft. above ground in good condition.

No markings visible.

DESCRIBE BEARING TREES OR OTHER OFFICIAL ACCESSORIES FOUND

2 badly rotted p. pine stumps bear N.62°E., approx. 17 ft. (fits GLO Notes)

A 26" p. pine stump bears S.72°W., approx. 21 ft. Some scribing visible (36). (Looks like 31 at first glance, closer inspection shows 36). (Location fits GLO Notes). There is an old B.T. tag in hole on west side. No evidence of NW B.T. (Cont. in block 12)

PHOTO IDENTIFICATION DATA

Photo No. _____

Filed At. _____

Object Ident. _____

Ident. By _____

Signature

DESCRIBE CORNER LOCATION RELATIVE TO NEAR-BY FEATURES, ALSO HOW TO REACH CORNER

Corner sets on NW facing slope, approx. 35 ft. east of a fence which runs approx. north-south (fence jogs across old road at this point).

Corner is approx. 60 ft. east of old road which is in the bottom of a small ravine.

PLANE COORDINATE POSITION DATA

State _____ Zone _____

X _____

Y _____

Estab. By _____

Agency

Signature	Title	Division	Headquarters	Date	7100-52-(3/68)
T. Hollamon	Eng, Tech,		S, O,	5/10/74	

CORNER RECORD (PERPETUATION)

MONUMENT: DESCRIBE NEW MONUMENT SET, OR WORK DONE TO PRESERVE EXISTING MONUMENT

ACCESSORIES : DESCRIBE NEW BT's WITNESS OBJECTS ETC. ESTABLISHED, OR WORK DONE TO PRESERVE EXISTING EVIDENCE

I put up no tags. It appears there are enough.

Work Done By _____ Title _____ Date _____ State Registration No. or Agency _____

Certified Cor. Record Prepared ? Yes No Filed At: _____ Date _____

REMARKS

(Cont. from block 3)

There was no SE B.T. There is a sectionline board on 26" Douglas-fir approx. 30 ft. west.

Index File No. T. R. M. Tract or Surv. No. Cor.