

Index  
File No. 5-25  
T 45 R. 30 & 31E  
Merid. Willamette

**CORNER RECORD (SEARCH)**  
(Ref. FSM 7151.4)

R.D. Ukiah County Umatilla State Oregon  
Tract or Survey No. \_\_\_\_\_ Cor. No. \_\_\_\_\_  
N.F. Umatilla

**CORNER DIAGRAM**

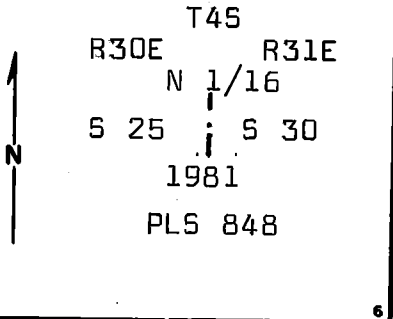

**DESCRIBE CORNER MONUMENT FOUND**  
Corner not previously established.

**DESCRIBE BEARING TREES OR OTHER OFFICIAL ACCESSORIES FOUND**  
N/A

**PHOTO IDENTIFICATION DATA**  
Photo No. \_\_\_\_\_  
Filed At. \_\_\_\_\_  
Object Ident. \_\_\_\_\_  
Ident. By \_\_\_\_\_  
*Signature*

**DESCRIBE CORNER LOCATION RELATIVE TO NEAR-BY FEATURES, ALSO HOW TO REACH CORNER**  
Corner is on gentle North slope in open timber. Ridge road, coursing SE approx. 1000 ft. South from corner.

**PLANE COORDINATE POSITION DATA**  
State \_\_\_\_\_ Zone \_\_\_\_\_  
X \_\_\_\_\_  
Y \_\_\_\_\_  
Estab. By \_\_\_\_\_  
*Agency*

*Signature*

Title \_\_\_\_\_ Division \_\_\_\_\_ Headquarters \_\_\_\_\_ Date \_\_\_\_\_  
PLS 848 Mt. Vernon, OR 7/28/81

**CORNER RECORD (PERPETUATION)**

**MONUMENT: DESCRIBE NEW MONUMENT SET, OR WORK DONE TO PRESERVE EXISTING MONUMENT**

Set 3"x30" galv. iron pipe with 3" brass cap stamped as shown on the diagram. Set pipe 16 inches in the ground and raised a mound of stone around the pipe.

From which:

**ACCESSORIES : DESCRIBE NEW BT'S WITNESS OBJECTS ETC. ESTABLISHED, OR WORK DONE TO PRESERVE EXISTING EVIDENCE**

A pine 16 inches dia. bears N39°E, 7.7 ft. scribed N 1/16 S 30 BT.  
A pine 16 inches dia. bears S64°W, 8.5 ft. scribed N 1/16 S 25 BT.  
Set steel posts with warning and bounday signs 6 ft. West and 5 ft. South from corner.  
Nailed brass washers stamped PLS 848 and bearing tree signs to each tree.  
Painted red band around each tree.

Work Done By D.M. Ferguson Title Surveyor Date 7/28/81 State Registration No. or Agency OR PLS 848

Certified ~~RECORDED~~ ~~Deposited~~? Yes  No  Filed At: Umatilla Co. Surveyor Off. Date

**PROFESSIONAL  
LAND SURVEYOR**

**REMARKS**

Witnesses to above corner:  
D. Mitchell Ferguson  
Mike Woodward

**OREGON  
JULY 12, 1968  
DOUGLAS M. FERGUSON  
848**