

Index
File No. N-5

CORNER RECORD (SEARCH)

(Ref. FSM 7151.4)

Tract or

Survey No. _____

No. _____

66

T 4S R. 30E

R.D.

Ukiah

County

UmatillaMerid. Willamette

N.F.

Umatilla

State

Oregon

CORNER DIAGRAM

T4S R30E

S 18 | S 17

S 19 | S 20

1981

PLS 848

PHOTO IDENTIFICATION DATA

Photo No. _____

Filed At: _____

Object Ident. _____

Ident. By _____

Signature

PLANE COORDINATE POSITION DATA

State _____ Zone _____

X _____

Y _____

Estab. By _____

*Agency**Signature*

Title

PLS 848

Division

Headquarters

Mt. Vernon, OR

Date

9/81

7100-52-(3/68)

DESCRIBE CORNER MONUMENT FOUND

Found 18"x14"x12" stone set 12 in. in the ground with 3 grooves on South face and 5 notches on East edge, set in mound of stone on steep S.W. slope.

From which

DESCRIBE BEARING TREES OR OTHER OFFICIAL ACCESSORIES FOUND

Found a pine 40 in. dia. bears $528^{\circ}E$, 30.0 ft. scribing visible. Found a pine 22 in. dia. bears $N66^{\circ}E$, 65.0 ft scribing reads 4S R30E S 17.

Other trees are dead, down and burned and have rolled downhill.

Accepted center of stone as corner position.

DESCRIBE CORNER LOCATION RELATIVE TO NEAR-BY FEATURES, ALSO HOW TO REACH CORNER

Corner is on steep rocky S.W. slope, North and West fence corner 30 ft. SE from corner.

Fence line can be followed from top of ridge downhill (South) to the Section Corner.

Signature

Title

Division

Headquarters

Date

7100-52-(3/68)

Mt. Vernon, OR

9/81

CORNER RECORD (PERPETUATION)

MONUMENT: DESCRIBE NEW MONUMENT SET, OR WORK DONE TO PRESERVE EXISTING MONUMENT

Set 3"x30" galv. iron pipe with 3" brass cap stamped as shown on the diagram, set 18 inches in the ground and raised a mound of stone around the pipe. Set original stone North alongside the pipe.

From which

ACCESSORIES : DESCRIBE NEW BT'S WITNESS OBJECTS ETC. ESTABLISHED, OR WORK DONE TO PRESERVE EXISTING EVIDENCE

A pine 12 in. dia. bears N43°W, 47.5 ft. scribed T45 R30E S 18 BT.
 A pine 5 in. dia. bears N41°E, 16.1 ft. scribed X BT.
 A fir 12 in. dia. bears S70°E, 33.0 ft. scribed T45 R30E S 20 BT.
 A pine 9 in. dia. bears S85°W, 22.1 ft. scribed T45 R30E S 19 BT.
 Set steel posts with warning & bdry. signs 5' N & 5' W from corner.
 Nailed bearing tree signs and brass washers stamped PLS 848 to each tree.
 Painted red band around each tree.

Work Done By D.M. Ferguson Title Surveyor Date 9/81 State Registration No. OR PLS 848
 or Agency

~~Certified Copy Record Prepared~~ ? Yes No Filed At: Umatilla Co. Surveyor Off. Date

PROFESSIONAL
LAND SURVEYOR

REMARKS

Witnesses to above corner:

D. Mitchell Ferguson
Mike Woodward

OREGON
JULY 12, 1968
DOUGLAS M. FERGUSON
848

Index
File No. N-5

CORNER RECORD (SEARCH)

(Ref. FSM 7151.4)

Tract or
Survey No. 4-150 Cor. No. N-5

T 4S R. JOE R.D. Ukiah County Umatilla
Merid. Willamette N.F. Umatilla State Oregon

CORNER DIAGRAM

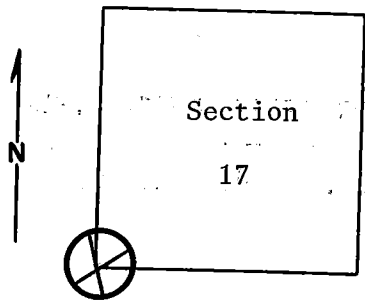

DESCRIBE CORNER MONUMENT FOUND

Material: None.

Entire area of corner is a mass of stones. Cannot find markings.

DESCRIBE BEARING TREES OR OTHER OFFICIAL ACCESSORIES FOUND

A 22-inch p.pine scribed on SW face. Scribing visible. It is original NE B.T.

A 40-inch p.pine with long upper blaze and small lower blaze. Has been scorched on NW face, and scribing is not visible. I believe it is the SE B.T.

There are old, down and rotting partly burned p.pines in approximately the proper (cont. in Block 12.)

DESCRIBE CORNER LOCATION RELATIVE TO NEAR-BY FEATURES, ALSO HOW TO REACH CORNER

Location is on steep SW-facing slope. Fence corners on SE B.T. Fences run north and west. An old road passes through the fence approximately 1000 feet north of corner (on gentle NW slope).

PHOTO IDENTIFICATION DATA

Photo No. _____
Filed At. _____
Object Ident. _____
Ident. By _____
Signature

PLANE COORDINATE POSITION DATA

State _____ Zone _____
X _____
Y _____
Estab. By _____
Agency

Signature T. Hollamon Title Engineering Technician Division S. O. Headquarters S. O. Date June 20, 1974 7100-52-(3/68)

CORNER RECORD (PERPETUATION)

MONUMENT: DESCRIBE NEW MONUMENT SET, OR WORK DONE TO PRESERVE EXISTING MONUMENT

ACCESSORIES: DESCRIBE NEW B.T.'s WITNESS OBJECTS ETC. ESTABLISHED, OR WORK DONE TO PRESERVE EXISTING EVIDENCE

I placed blank B.T. tags on the two live trees as well as on the two down tree remnants.

I also placed a location poster on gate post where road crosses fence approximately 1000 feet north.

Work Done By _____ Title _____ Date _____ State Registration No. or Agency _____

Certified Cor. Record Prepared? Yes No Filed At: _____ Date _____

REMARKS

(Block #3, cont.)
places for both the SW and NW B.T.'s.

Index File No. T. R. M. Tract or Surv. No. Cor.