

Index
File No. N-15

CORNER RECORD (SEARCH)

(Ref. FSM 7151.4)

Tract or
Survey No. _____ No. _____

T 45 R. 30E

R.D. Ukiah County Umatilla

Merid. Willamette

N.F. Umatilla State Oregon

CORNER DIAGRAM

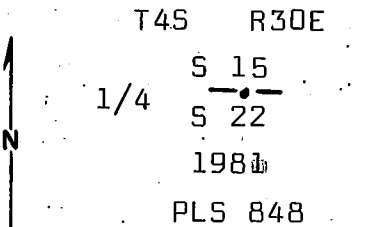

DESCRIBE CORNER MONUMENT FOUND

Found 12"x10"x5" stone, when set upright marked 1/4 on North face, set in a circle of stone.

From which:

DESCRIBE BEARING TREES OR OTHER OFFICIAL ACCESSORIES FOUND

A pine 30 in. dia. with grown-over blaze, bears S24°E, 36.0 ft. (GLO notes call S50°E, 38 ft.). Pine is live in good condition.

A stump hole bears approx. N60°E, 13.0 ft. GLO notes call 13 in. pine N42°E, 17.0 ft.) Accepted center of stone as 1/4 cor. position

PHOTO IDENTIFICATION DATA

Photo No. _____
Filed At: _____
Object Ident. _____
Ident. By _____
Signature

DESCRIBE CORNER LOCATION RELATIVE TO NEAR-BY FEATURES, ALSO HOW TO REACH CORNER

Corner is on flat ground in open pine timber just South on an E-W fence line. Corner can be reached by following the fence from the East or West.

PLANE COORDINATE POSITION DATA

State _____ Zone _____
X _____
Y _____
Estab. By _____
Agency

Signature

Title _____ Division _____ Headquarters _____ Date _____ 7100-52-(3/68)
PLS 848 Mt. Vernon, DR 9/81

CORNER RECORD (PERPETUATION)

MONUMENT: DESCRIBE NEW MONUMENT SET, OR WORK DONE TO PRESERVE EXISTING MONUMENT

Set 3"x30" glav. iron pipe with 3" brass cap, stamped as shown on the diagram. Set 20 inches in the ground. Set original stone alongside pipe and placed a small mound of stone around the pipe.

From which:

ACCESSORIES: DESCRIBE NEW BT'S WITNESS OBJECTS ETC. ESTABLISHED, OR WORK DONE TO PRESERVE EXISTING EVIDENCE

A pine 11 in. dia. bears N50°W, 13.4 ft. scribed 1/4 S 15 BT.
A pine 12 in. dia. bears S25°W, 33.4 ft. scribed 1/4 S 22 BT.
Set steel posts with warning and boundary signs 5 ft. East and 5 ft. West from corner.
Nailed bearing tree signs and brass washers stamped PLS 848 to each tree.
Painted a red band around each tree.

Work Done By D.M. Ferguson Title Surveyor Date 9/81 State Registration No. OR PLS 848
or Agency

Certified for Record Prepared? Yes No Filed At: Umatilla Co. Surveyor Off Date

**PROFESSIONAL
LAND SURVEYOR**

REMARKS

Witnesses to above corner:

Dan Martin
Dave Herburger

OREGON
JULY 12, 1968
DOUGLAS M. FERGUSON
848

Index File No. N-15 **CORNER RECORD (SEARCH)** (Ref. FSM 7151.4) Tract or Survey No. _____ Cor. No. _____
 T 4 S. R. 30 E. R.D. Ukiah County Umatilla
 Merid. Willamette N.F. Umatilla State Oregon

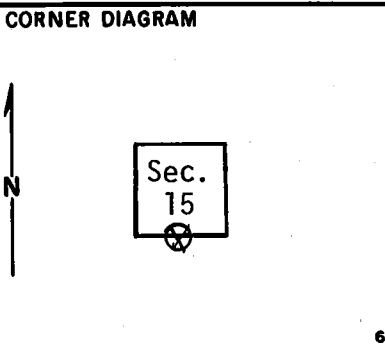

DESCRIBE CORNER MONUMENT FOUND
 Stone mound, mound 2' diam., 8" deep, 8" above ground, fair condition. No markings visible. 2

DESCRIBE BEARING TREES OR OTHER OFFICIAL ACCESSORIES FOUND
 A 28" p.pine bears S240E., approx. 36 ft. It has upper and lower closed scars which resemble B.T. blazes. It has a blank B.T. tag on north side and an Attention (warning) sign on south side. However, it does not fit original GLO Notes (which says S500E., 58 links). One of 3 things, either it is not the original B.T. or it was mislocated, or the stone mound is not in its original position. (cont. in block 12) 3

PHOTO IDENTIFICATION DATA
 Photo No. _____
 Filed At. _____
 Object Ident. _____
 Ident. By _____
Signature _____ 7

DESCRIBE CORNER LOCATION RELATIVE TO NEAR-BY FEATURES, ALSO HOW TO REACH CORNER
 Mound sets approx. in an east-west fence line. Location is in edge of timber above open south slope. Quarter corner could easily be re-located from section corner west (mostly open). 4

PLANE COORDINATE POSITION DATA
 State _____ Zone _____
 X _____
 Y _____
 Estab. By _____
Agency _____ 8

Signature T, Hollamon Title Eng, Tech, Division _____ Headquarters S, O, Date 5/16/74 7100-52-(3/68) 5

CORNER RECORD (PERPETUATION)

MONUMENT: DESCRIBE NEW MONUMENT SET, OR WORK DONE TO PRESERVE EXISTING MONUMENT

ACCESSORIES : DESCRIBE NEW BT'S WITNESS OBJECTS ETC. ESTABLISHED, OR WORK DONE TO PRESERVE EXISTING EVIDENCE

Work Done By _____ Title _____ Date _____ State Registration No. or Agency _____

Certified Cor. Record Prepared ? Yes No Filed At: _____ Date _____

REMARKS

There is an old location poster on a down pole beside the stone mound. There is an old rotting pine stump (up-rooted) in the approximate location where the SE B.T. was described. No evidence of NE B.T.

Index File No. T. R. M. Tract or Surv. No. Cor.

H-15

45

30E