

OREGON CORNER RESTORATION FORM

Section 6 Township 4S Range 30E  
 County Umatilla Date: 7-Apr-22

Corner Designation: 4S30E3 X Condition report only  
 Not Found  
 Remonumented  
 Unrecorded  
 Surveyed In  
 Referenced Out

Quarter corner common to sections 6 and 7, T3S, R29E,  
 W.M., Umatilla County, Oregon.

Previous Renewals, Surveys, etc...

This corner was originally set by George Pershin under Contract No. 430, Dated March 23rd, 1882. His record reads: Set basalt stone 17x10x4 in mound of stone on stony S.W. hillside for 1/4 Sec. Cor., Marked 1/4 on N. face. No trees; raised mound of stone along side in lieu of pits.

Monument and accessories found: (condition and source)

Found a basalt stone 16x7x4 plainly marked 1/4 firmly set but leaning downhill to the west in the remains of a stone mound.

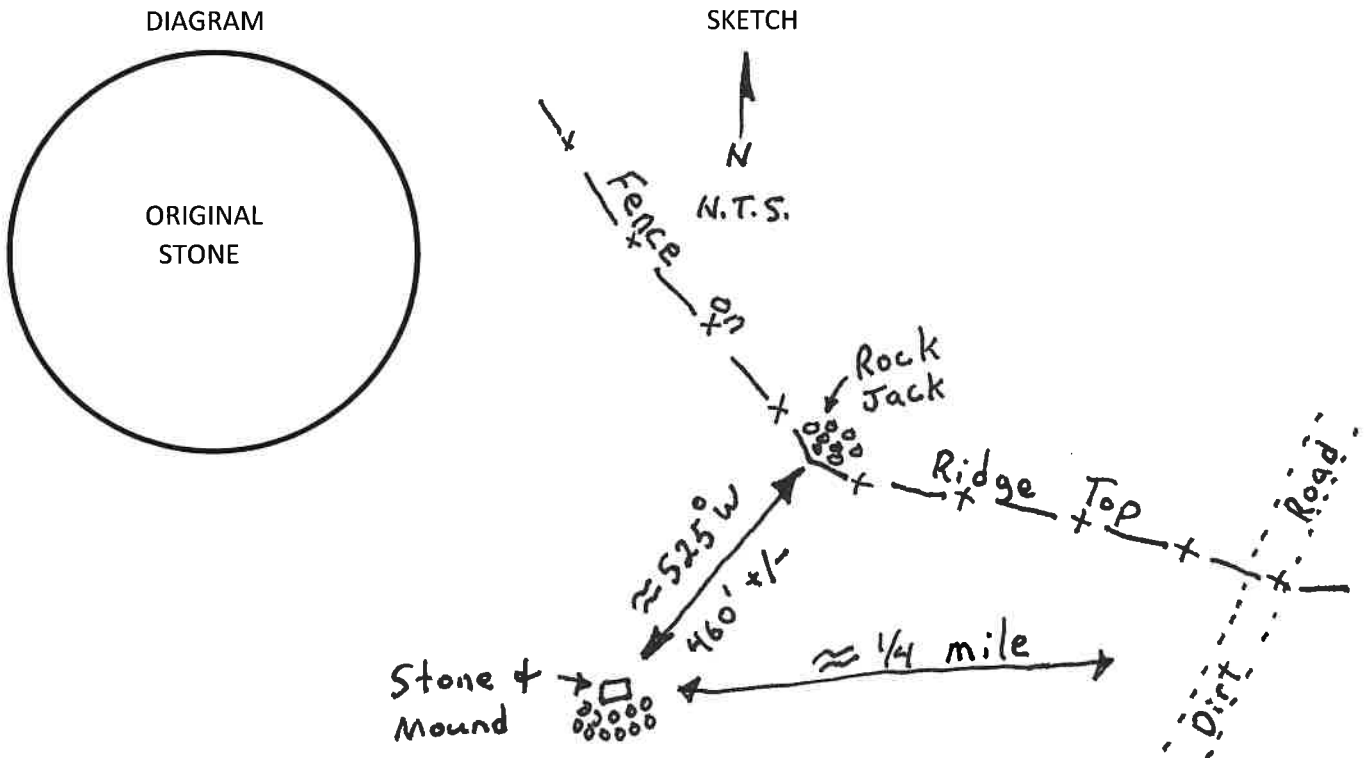

MONUMENT(S) AND ACCESSORIES SET (Procedures and Description)

At the corner point I dig and reset the original stone 12 inches in the ground in a vertical position with the marks "1/4" on the north face as when found. I rebuilt the mound of stone 3' diameter and 1.5' high along the south side of the stone. This stone and mound were witnessed by Mr. Charles Doherty, 1214 NW King Avenue, Pendleton, OR 97801.

Measurements were made with a Trimble R8S base/rover RTK GPS system.

Location and comments:  
 Approximate coordinate SP NAD83  
 Northing = 577468.4'  
 Easting = 8553025.2'  
 RECEIVED BY:  
Umatilla County Surveyor  
 Date: 8/1/22  
 Rec'd By: CT  
 No. 22-083-C

Compass Declination  
 Firm / Agency  
 Witness Tree Surveying  
 Address  
 P.O. Box G  
 Pilot Rock, OR 97868  
 Party Chief  
 Stephen K. Haddock

Surveyor's Seal

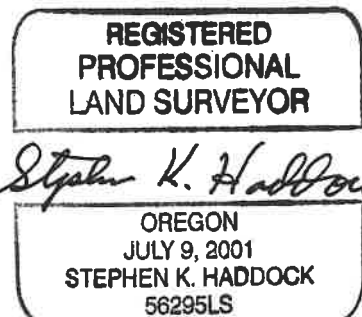

RENEWS: 6-30-23