

CERTIFIED RECORD OF LAND CORNER MONUMENTATION

History of original corner establishment:

Corner originally established by Frank W. Campbell in 1883 under General Land Office contract number 468. Corner was remonumented by Otis S. Gould for the U.S. General Land Office in July of 1939. Surveyor Gould record states:

The 1/4 section corner which has been perpetuated with a stone 9"x8"x6" firmly set with no visible marks. At point for corner set an iron post 3 feet long, 1 inch diameter, 27 inches in the ground with the perpetuated stone deposited at the base for 1/4 section corner. (Brass cap marked as shown below) From which:

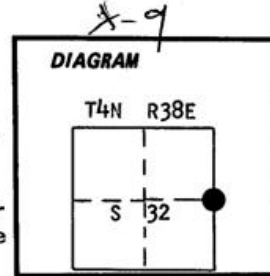

A dead pine 24 inches in diameter bears N82°E, 93 lks dist marked 1/4 S BT

A pine 24 inches in diameter bears S68°W, 59 lks dist marks grown over

Description of corner evidence found:

Found 1 inch galvanized iron pipe with 2 1/2" brass cap marked as shown below, firmly set 3 inches above ground.

A 20 inch diameter (record 24") pine, dying and standing, chopped out blaze, scribes visible, bears S68°W, 57 lks. (blaze does not face corner)

Also found a 1 inch drill rod 1.57 feet East of brass cap. (No previous record found)

Description of monument and accessories established to perpetuate the original location of this corner:

New BTs

A 24 inch diameter Lodgepole Pine bears N77°W 55.7 feet marked 1/4 S32 BT on single blaze
 A 30 inch diameter Spruce bears S49°E 90.3 feet marked 1/4 S33 BT on a single blaze

Set a steel fencepost approximately 5 feet South with 54-2 and 54-4 signs attached
 Set a steel fencepost approximately 5 feet West with 54-2 sign attached

Trees taken July 11, 1985

Witness: Ray Crapo

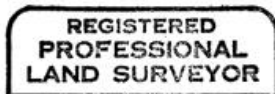

Gregory T. Blackman

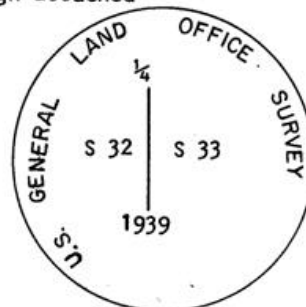
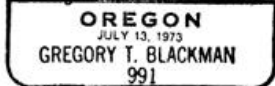

I used a steel tape and magnetic compass in the establishment of these accessories. I used 20° East magnetic declination and the distances are to the center of the tree. I set a brass washer marked OPLS 991 by the BT blaze. I painted a 6 inch red band around all BTs and attached 54-3 and 54-4 signs.

Office of..... County of.....
 State of....., I hereby certify that the within instrument was filed in this office for record on the..... day of....., 19.....
 by
 (COUNTY OFFICIAL) (DEPUTY)

Form R6-7100-57 (9/71)

RECEIVED BY
 Umatilla County Surveyor
 Date 7-24-85
 Rec'd By JA
 No. 85-85-R
 (81-B)