

Index  
 File No. W-17  
 T 4N. R. 38E  
 Merid. W.M.

**CORNER RECORD (SEARCH)**

(Ref. FSM 7151.4)

Tract or Survey No. \_\_\_\_\_ Cor. No. \_\_\_\_\_

R.D. Walla Walla County Umatilla  
 N.F. Umatilla State \_\_\_\_\_ Or. \_\_\_\_\_

**CORNER DIAGRAM**



T4N R38E  
927 | 926  
934 | 935

**DESCRIBE CORNER MONUMENT FOUND**

2" iron pipe with 2 1/2" brass cap  
 (G.L.O..) mkd..:

T4N R38E  
927 | 926  
934 | 935  
 1939

**DESCRIBE BEARING TREES OR OTHER OFFICIAL ACCESSORIES FOUND**

L. Pine, 29", N18°E, 55.4'; scribing visible.  
 Sawn stump, -2' dia., N47 1/4°W, 80.5'; scribing visible..

W. Fir snag, 36", S54°W, 134.6'; scribing visible.  
 D. Fir, 36", S11°E, 372.2'; healed blaze.

**PHOTO IDENTIFICATION DATA**

Photo No. \_\_\_\_\_  
 Filed At. \_\_\_\_\_  
 Object Ident. \_\_\_\_\_  
 Ident. By \_\_\_\_\_  
*Signature*

**DESCRIBE CORNER LOCATION RELATIVE TO NEAR-BY FEATURES, ALSO HOW TO REACH CORNER**

Cor. falls in open on Sly slope. Cor. is NWly of 64 rd. and is visible from rd.

**PLANE COORDINATE POSITION DATA**

State \_\_\_\_\_ Zone \_\_\_\_\_  
 X \_\_\_\_\_  
 Y \_\_\_\_\_  
 Estob. By \_\_\_\_\_  
*Agency*

*Signature*  
*FL Munro*

Title PLS Division \_\_\_\_\_ Headquarters \_\_\_\_\_

Date 11/21/91 FS-7100-52 (3/68)

2

3

4

5

**CORNER RECORD (PERPETUATION)**

**MONUMENT: DESCRIBE NEW MONUMENT SET, OR WORK DONE TO PRESERVE EXISTING MONUMENT**

None.

9

**ACCESSORIES : DESCRIBE NEW BT'S WITNESS OBJECTS ETC. ESTABLISHED, OR WORK DONE TO PRESERVE EXISTING EVIDENCE**

Spruce, 10", N41°W, 94.8'; mkd.: T4N R38E S27 BT

W. Fir, 11", S32°W, 185.4'; mkd.: T4N R38E S34 BT

L. Pine, 8", S11°E, 261.3'; mkd.: T4N R38E S35 BT

BTs have red blaze and band, BT tags and 54-9 signs. New BTs have alum.  
"PLS 1832" washers. 6' fence post with 54-9 sign within 5' of cor.

10

Work Done By F.S. Munro Title PLS Date 11/21/91 State Registration No. 1832  
or Agency

Certified Cor. Record Prepared? Yes  No  Filed At: Umatilla Co. Surveyor Date

11

**REMARKS**

12

Index File No. V-17T. 4N R. 38E M. W.M. Tract or Surv. No.                      Cor.                     

13

Index File No. V-17  
 T 4 N R. 30 E  
 Merid. Will.

CORNER RECORD (SEARCH)

(Ref. FSM 7151.4)

R.D. Walla Walla County Umatilla  
 N.F. Umatilla State OR  
 Tract or Survey No. \_\_\_\_\_ Cor. No. \_\_\_\_\_

CORNER DIAGRAM

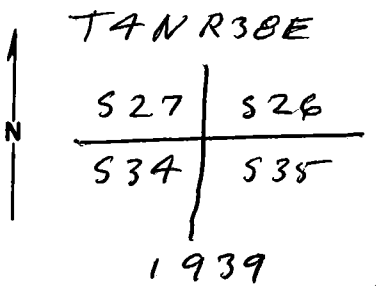

PHOTO IDENTIFICATION DATA

Photo No. 880-25  
 Filed At. Pendleton  
 Object Ident. Prognosis  
 Ident. By D. Edwards  
 Signature

PLANE COORDINATE POSITION DATA

State \_\_\_\_\_ Zone \_\_\_\_\_  
 X \_\_\_\_\_  
 Y \_\_\_\_\_  
 Estab. By \_\_\_\_\_  
 Agency

DESCRIBE CORNER MONUMENT FOUND

Found 2" Iron pipe with B.C. in large pile of stone stamped as diagram

DESCRIBE BEARING TREES OR OTHER OFFICIAL ACCESSORIES FOUND

- A 28" Pino Bears N 18° E 554 ft. some marks vis.
- A 33" Fir Bears S 11° E 372.2 ft Blaze Healed
- A 24" Fir Bears S 54° W 134.6 ft some marks visible on partially healed Blaze
- A 24" Fir Bears N 47 1/4° W 80.5 ft. some marks visible on partially healed Blaze

DESCRIBE CORNER LOCATION RELATIVE TO NEAR-BY FEATURES, ALSO HOW TO REACH CORNER

From Jct Rd #6403 with Rd #64  
 Go North on Rd #64 0.1 mile  
 Corner is 50 ± West of Rd.

Signature D. Dennis Edwards Title LS Division \_\_\_\_\_ Headquarters Hermiston Date 7/19/05 7100-52 (3. 68)

CORNER RECORD (PERPETUATION)

MONUMENT: DESCRIBE NEW MONUMENT SET, OR WORK DONE TO PRESERVE EXISTING MONUMENT

ACCESSORIES: DESCRIBE NEW BT'S WITNESS OBJECTS ETC. ESTABLISHED, OR WORK DONE TO PRESERVE EXISTING EVIDENCE

I drove a steel fence post 3 ft. East & attached 54-4  
Painted BT Blazes Rod & red band around & <sup>sign</sup>  
nailed any missing 54-3 & 54-4 signs to them.

Work Done By G. D. Edwards Title LS Date 7/19/85 State Registration No. 951  
or Agency

Certified Cor. Record Prepared? Yes  No  Filed At: \_\_\_\_\_ Date \_\_\_\_\_

REMARKS

Index File No. V-17 T. 4N R. 38E M. 411 Tract or Surv. No. \_\_\_\_\_ Cor. \_\_\_\_\_

V-17 *Prw. report*

Index  
 File No. V-17  
 T 4N R. 38E  
 Merid. Willamette

**CORNER RECORD (SEARCH)**  
 (Ref. FSM 7151.4)

Tract or  
 Survey No. \_\_\_\_\_  
 Cor. No. 124  
 Sec. \_\_\_\_\_  
 R.D. Walla Walla County Umatilla & Union Line  
 N.F. Umatilla State Oregon

CORNER DIAGRAM

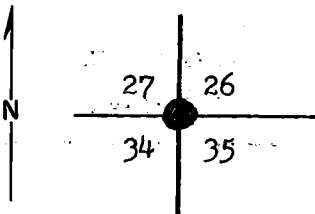

DESCRIBE CORNER MONUMENT FOUND

Material: Brass cap  
 Height above ground: 2'  
 Condition: Good  
 Markings: 1939 U.S. General Land Office Survey

DESCRIBE BEARING TREES OR OTHER OFFICIAL ACCESSORIES FOUND

BT S26 - lodgepole, N8E, 55', BT tag, 26dbh  
 BT-S27 - Subalpine fir, N40W, 80', BT tag. "T4N R38E S27"

PHOTO IDENTIFICATION DATA

Photo No. EQO 18-183  
 Filed At. Walla Walla  
 Object Ident. Stereo field  
 Ident. By *A. Skoglund*  
*Signature*

DESCRIBE CORNER LOCATION RELATIVE TO NEAR-BY FEATURES, ALSO HOW TO REACH CORNER

PLANE COORDINATE POSITION DATA

State \_\_\_\_\_ Zone \_\_\_\_\_  
 X \_\_\_\_\_  
 Y \_\_\_\_\_  
 Estab. By \_\_\_\_\_  
*Agency*

Signature Skoglund

Title Forester

Division P.M.

Headquarters Walla Walla

Date 10-5-69

7100-52 (3/68)

CORNER RECORD (PERPETUATION)

MONUMENT : DESCRIBE NEW MONUMENT SET, OR WORK DONE TO PRESERVE EXISTING MONUMENT

9

ACCESSORIES : DESCRIBE NEW BT's WITNESS OBJECTS ETC. ESTABLISHED, OR WORK DONE TO PRESERVE EXISTING EVIDENCE

10

Work Done By \_\_\_\_\_ Title \_\_\_\_\_ Date \_\_\_\_\_ State Registration No. or Agency \_\_\_\_\_

Certified Cor. Record Prepared ? Yes No Filed At: \_\_\_\_\_ Date \_\_\_\_\_

11

REMARKS

12

Index File No. *V-17* T. R. M. Tract or Surv. No. Cor. \_\_\_\_\_

13