

USDA-FOREST SERVICE

INDEX

FILE NO. V-1 CORNER RECORD (SEARCH) Tract or Cor.
 (Ref. FSM 7151.4) Survey No. No.
 T. 4 N R. 38 E R.D. Walla Walla County Umatilla
 Merid. Willamette N.F. UWATILLA State Oregon 1

CORNER DIAGRAM T4N 1 DESCRIBE CORNER MONUMENT FOUND
 1 R37E R38E 1 Found standard GLO brass cap stamped as shown in diagram.
 1 S25 | S30 1
 N ----- 1
 1 S36 | S31 1 ----- 2
 1 1939 1 DESCRIBE BEARING TREES OR OTHER OFFICIAL ACCESSORIES FOUND

----- 1 Found 7" White Fir N22 1/2°E, 23.7' with visible scribe.
 PHOTO IDENTIFICATION DATA 1 Found 14" White Fir S42 1/2°E, 32.9' with visible scribe.
 Photo No. ----- 1 Found 10" White Fir S62 1/2°W, 39.0' with visible scribe.
 Filed At. ----- 1 Found 20" Engleman Spruce N38 1/2°W, 32.4' with visible scribe.
 Object Ident. ----- 1
 Ident. By ----- 1
 Signature 71 ----- 3

----- 1
 PLANE COORDINATE POSITION DATA 1 DESCRIBE CORNER LOCATION RELATIVE TO NEAR-BY FEATURES, ALSO HOW TO REACH CORNER
 State ----- Zone ----- 1 The corner may be reached by traveling Highway 204 west from the Tollgate Store 1.2 mile to
 X ----- 1 a sharp curve turning from northwest to southwest at the bottom of the hill. An opening is
 Y ----- 1 just west of some cabins to the north. Go 1700' west from the Highway to the corner.
 Estab. By ----- 1
 Agency 81 ----- 4

----- 1
 Signature Title Division Headquarters Date FS-7100-52 (3/68)
 Surveyor Pendleton, OR 9-04-95
 ----- 5

CORNER RECORD (PERPETUATION)

MONUMENT : DESCRIBE NEW MONUMENT SET, OR WORK DONE TO PRESERVE EXISTING MONUMENT
Cleared brush and debris away from corner.

9

ACCESSORIES : DESCRIBE NEW BT'S WITNESS OBJECTS ETC. ESTABLISHED, OR WORK DONE TO PRESERVE EXISTING EVIDENCE
None set.

10

Work Done By. David L. Haddock Title Land Surveyor Date 8-15-95 State Registration No. _____
Certified Cor. Record Prepared? Yes No or Agency PLS 852
Filed At: Umatilla County Surveyor Date 9-95 11

REMARKS

12

Index File No. V-1 T. 4 N. R. 38 E. M. Willamette Tract or Surv. No. _____ Cor. _____ 13
GPO : 1984 O - 439-095

Index
File No. 5 V-1

CORNER RECORD (SEARCH)
(Ref. FSM 7151.4)

Tract or Survey No. _____
Cor. No. Y-1

T 4 N. R. 38 E. R.D. Pendleton County _____
Merid. Willamette N.F. Umatilla State Oregon

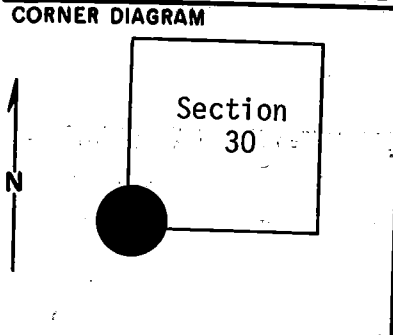

DESCRIBE CORNER MONUMENT FOUND

Brass Cap. Size: $2\frac{1}{2}$ ".
(Found on 4/6/78 B.C.C.)

DESCRIBE BEARING TREES OR OTHER OFFICIAL ACCESSORIES FOUND

20" dead fir bears S 66° W, 40 links distance with blaze closed facing corner.
14" snag bears S 48° E, 34' distance, scribed: S 31.
24" fir stump bears N 0° E, 14' distance. Stump is 2' high. Bits of scribing on south face.

PHOTO IDENTIFICATION DATA

Photo No. _____
Filed At. _____
Object Ident. _____
Ident. By _____
Signature

DESCRIBE CORNER LOCATION RELATIVE TO NEAR-BY FEATURES, ALSO HOW TO REACH CORNER

(This corner is app. 15 ch S70E of Walter Wills outcrop ledge. app. 14 ch. N is the power line. Now bearing trees needed. B.C.C.)

PLANE COORDINATE POSITION DATA

State _____ Zone _____
X _____
Y _____
Estab. By _____
Agency

Signature B. Moore Title Engineering Technician Division _____ Headquarters S. O. Date July 1975

CORNER RECORD (PERPETUATION)

DATE (month to year)

2

MONUMENT: DESCRIBE NEW MONUMENT SET, OR WORK DONE TO PRESERVE EXISTING MONUMENT

9

ACCESSORIES: DESCRIBE NEW BT'S WITNESS OBJECTS ETC. ESTABLISHED, OR WORK DONE TO PRESERVE EXISTING EVIDENCE

10

Work Done By _____ Title _____ Date _____ State Registration No. _____ or Agency _____

Certified Cor. Record Prepared? Yes No Filed At: _____ Date _____

11

REMARKS

12

Index File No. _____ Tract or Surv. No. _____ Cor. _____ M. _____

13