

USDA-FOREST SERVICE

INDEX
 FILE NO. R-3
 T. 4 N R. 38 E R.D. Walla Walla
 Merid. Willamette N.F. UMATILLA
 Tract or Survey No. _____
 County Umatilla
 State Oregon
 Cor. No. _____

CORNER DIAGRAM
 1 DESCRIBE CORNER MONUMENT FOUND
 1 S19 1 Found standard 2 1/2" GLO brass cap stamped as shown in the diagram.
 1 1/4 --- 1
 N S30 1
 1 1939 1
 1 _____ 2

1 DESCRIBE BEARING TREES OR OTHER OFFICIAL ACCESSORIES FOUND
 1 Found rotted remains of fir N34°E, 172'. No identifiable marks on tree.

PHOTO IDENTIFICATION DATA
 Photo No. _____
 Filed At. _____
 Object Ident. _____
 Ident. By _____
 Signature 71

PLANE COORDINATE POSITION DATA 1 DESCRIBE CORNER LOCATION RELATIVE TO NEAR-BY FEATURES, ALSO HOW TO REACH CORNER
 State _____ Zone _____ 1 The corner may be reached by traveling the McIntyre Road from the Tollgate Store 1.4 mile
 X _____ 1 to a long rock opening along a ridge. The road passes through a small finger of timber
 Y _____ 1 extending across the road into the opening. The lone bearing tree is in this stringer at the
 Etab. By _____ 1 west side of the road. The corner is out in the opening S57 55"W, 189.6' from this tree.
 Agency 81

Signature Title Division Headquarters Date FS-7100-52 (3/68)
 Surveyor Pendleton, OR 9-04-95

1
2
3
4
5

CORNER RECORD (PERPETUATION)

MONUMENT : DESCRIBE NEW MONUMENT SET, OR WORK DONE TO PRESERVE EXISTING MONUMENT
 Corner and stone mound in good shape.

9

ACCESSORIES : DESCRIBE NEW BT's WITNESS OBJECTS ETC. ESTABLISHED, OR WORK DONE TO PRESERVE EXISTING EVIDENCE

Set new bearing tree and objects.

A 22" dbh Alpine Fir bears N57°55'E, 189.6' scribed 1/4 S19 BT.

Set three 5/8" x 24" rebar with 2" aluminum caps stamped BO COR with bearing and distance to corner.

Cap N67°10"W, 48.5'; cap S30°32"W, 47.7'; and cap S73°24"E, 48.4'.

A brass washer stamped ORLS 852 and WALS 13922 is nailed between the letters B and T on the new tree with a brass screw.
 BT and LSM signs are attached. A red band is painted around the tree at chest height.

Work Done By. <u>David L. Haddock</u>	Title <u>Land Surveyor</u>	Date <u>8-17-95</u>	State Registration No. _____
Certified Cor. Record Prepared? <u>x</u>	Yes <u>Yes</u>	No <u>No</u>	or Agency <u>PLS 852</u>
		Filed At: <u>Umatilla County Surveyor</u>	Date <u>9-95</u>

11

REMARKS

12

Index File No. R-3 T. 4 N. R. 38 E. W. Willamette Tract or Surv. No. Cor.

13

Index
File No. R-3

CORNER RECORD (SEARCH)

(Ref. FSM 7151.4)

Tract or Survey No. _____ Cor. No. R-3

T 4 N R. 38 E

R.D. Walla Walla County

Merid. Willamette

N.F. Umatilla State Oregon

CORNER DIAGRAM

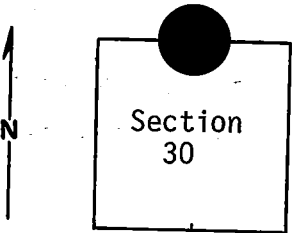

DESCRIBE CORNER MONUMENT FOUND

Brass Cap. Size: $2\frac{1}{2}$ ".
6" above ground;
good condition. In mound
of stone.

DESCRIBE BEARING TREES OR OTHER OFFICIAL ACCESSORIES FOUND

The one bearing tree is down and rotten (could find no scrib-
ing).

PHOTO IDENTIFICATION DATA

Photo No. _____
Filed At. _____
Object Ident. _____
Ident. By _____
Signature

DESCRIBE CORNER LOCATION RELATIVE TO NEAR-BY FEATURES, ALSO HOW TO REACH CORNER

PLANE COORDINATE POSITION DATA

State _____ Zone _____
X _____
Y _____
Estab. By _____
Agency

Signature B. Moore Title Engineering Technician Division _____ Headquarters S. O. Date August 1975

CORNER RECORD (PERPETUATION)

MONUMENT : DESCRIBE NEW MONUMENT SET, OR WORK DONE TO PRESERVE EXISTING MONUMENT

9

ACCESSORIES : DESCRIBE NEW BT's WITNESS OBJECTS ETC. ESTABLISHED, OR WORK DONE TO PRESERVE EXISTING EVIDENCE

10

Work Done By _____ Title _____ Date _____ State Registration No. _____
or Agency _____

Certified Cor. Record Prepared ? Yes No Filed At: _____ Date _____ 11

REMARKS

12

Index File No. 1 T. R. M. Tract or Surv. No. Cor. 13