

OREGON CORNER RESTORATION FORM

Section 13 Township 4N Range 36E
 County Umatilla Date: November 4, 2005

Corner Designation: 4N36N21

Corner to sections 13, 14, 23 and 24, T4N, R36E, W.M.,
 Umatilla County, Oregon.

Condition Report Only
 Not found
 Remonumented
 Unrecorded
 Surveyed in
 Referenced out

Previous Renewals / Surveys, etc.

Corner originally set by William H. Odell under contract No. 114 dated July 2, 1866. His record reads: Set post Cor for Secs. 13, 14, 23 & 24 on steep hillside facing the W.; drove charred stake and raised stone mound as per instructions.

Monument and Accessories found: (condition and source)

None. The position falls between the current fence and the remains of an east - west fence.

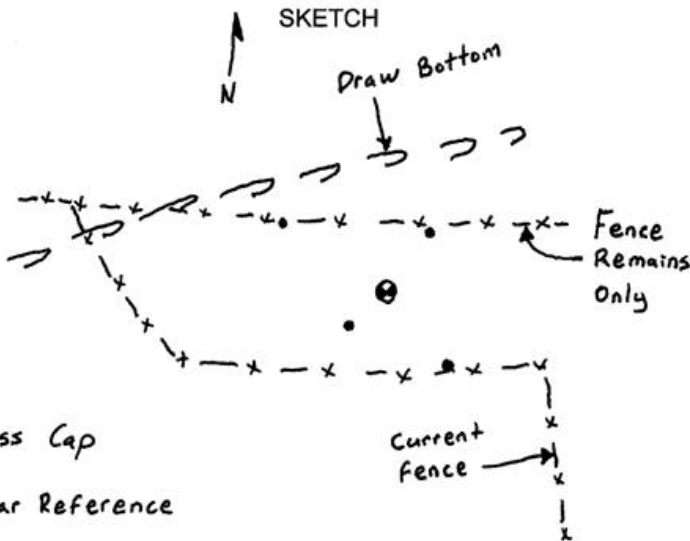
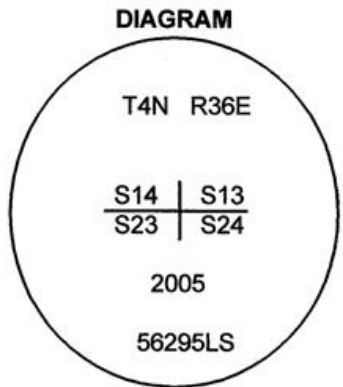

⊗ = Brass Cap
 ○ = Rebar Reference

MONUMENT (S) AND ACCESSORIES SET (Procedures and Description)

At the proportioned point I set a 1 1/2" x 30" galvanized iron pipe with a 2 1/4" brass cap attached stamped as shown in the diagram above, 36" in the ground.

For references, I set four, 5/8" by 24" rebars with 1 1/8" orange plastic caps attached, stamped WTS and 56295LS as described below:

- an iron rebar bears N22°21'03"W, 52.63 feet;
- an iron rebar bears N68°27'22"E, 60.32 feet;
- an iron rebar bears S83°17'53"W, 46.15 feet;
- an iron rebar bears S15°56'12"E, 44.10 feet;

The monument was set and references tied using a Trimble R7/R8 RTK GPS.

Location and comments

Compass Declination

Surveyors Seal

RECEIVED BY:
Umatilla County Surveyor
 Date: 11-05
 Rec'd By: KR
 No. 05-198-C

Firm / Agency
 Witness Tree Surveying
 Address
 P.O. Box G
 Pilot Rock, Or. 97868
 Party Chief
 Stephen K, Haddock

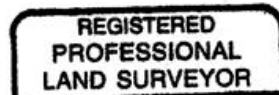

Stephen K. Haddock

