

OREGON CORNER RESTORATION FORM

Section 13 Township 4N Range 36E
 County Umatilla Date: November 3, 2005

Corner Designation: 4N36L23

Condition Report Only

Center 1/4 corner to Section 13, T4N, R36E W.M.
 Umatilla County, Oregon.

Not found
 Remonumented
 Unrecorded

 x Surveyed in
 x Referenced out

Previous Renewals / Surveys, etc.

There has been no previous establishment of a monument at this corner point.

Monument and Accessories found: (condition and source)

None.

DIAGRAM

SKETCH

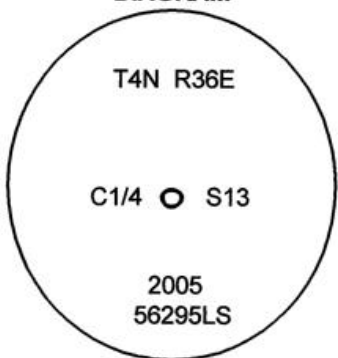

MONUMENT (S) AND ACCESSORIES SET (Procedures and Description)

I set a 1" x 24" iron rebar with a 2" aluminum Cap stamped as shown above 22" in the ground and built a collar of stone, 24" diameter to the top of the cap at the calculated center 1/4 location.

For references, I set four 5/8" by 24" iron rebars with 1 1/8" orange plastic caps stamped WTS and 56295LS as described below:

- a rebar bears N14°46'11"W, 35.85 feet;
- a rebar bears N77°19'04"E, 26.69 feet;
- a rebar bears N77°30'15"W, 35.92 feet;
- a rebar bears S38°25'47"E, 28.57 feet;

The monument was set and references tied using a Trimble R7/R8 RTK GPS.

Location and comments

Compass Declination

Surveyors Seal

RECEIVED BY:
Umatilla County Surveyor
 Date: 11-05
 Rec'd By: KK
 No. 05-198-C

Firm / Agency
 Witness Tree Surveying
 Address
 P.O. Box G
 Pilot Rock, Or. 97868
 Party Chief
 Stephen K, Haddock

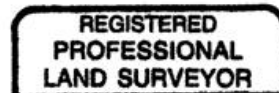

Stephen K. Haddock

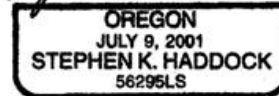

RENEWAL DATE 6-30-07