

**OREGON CORNER RESTORATION FORM**

Section 13 Township 4N Range 36E  
 County Umatilla Date: October 28, 2005

Corner Designation: 4N36J21

Condition Report Only  
 Not found  
 Remonumented  
 Unrecorded  
 Surveyed in  
 Referenced out

Corner to sections 11, 12, 13 and 14, T4N, R36E, W.M.,  
 Umatilla County, Oregon.

Previous Renewals / Surveys, etc.

Corner originally set by William H. Odell under contract No. 114 dated July 2, 1866. His record reads: Set post Cor for Secs. 11, 12, 13 & 14; drove charred stake, raised stone mound as per instructions.

Monument and Accessories found: ( condition and source )

I found a stone mound with the remains of the burnt wooden stake. The mound agrees with the original calls south to the road and also the projection of the centerline of County Road 30.

**DIAGRAM**

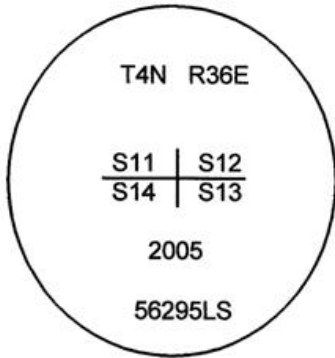

**SKETCH**

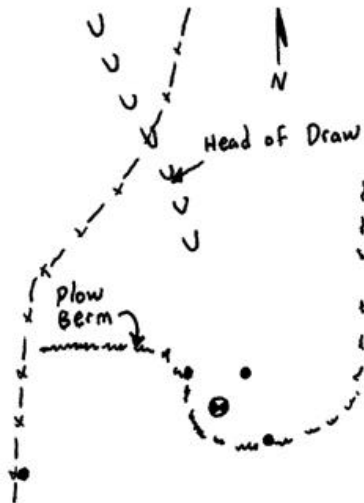

**MONUMENT (S) AND ACCESSORIES SET (Procedures and Description)**

At the position of the charred stake I set a 1 1/2" x 30" galvanized iron pipe with a 2 1/4" brass cap attached stamped as shown in the diagram above.

For references, I set four, 5/8" by 24" rebars with 1 1/8" orange plastic caps attached, stamped WTS and 56295LS as described below:

- an iron rebar bears N15°19'28"W, 37.31 feet;
- an iron rebar bears N34°34'48"E, 24.24 feet;
- an iron rebar bears S57°11'36"E, 54.64 feet;
- an iron rebar bears S71°30'44"W, 284.32 feet under an existing fence;

The monument and references were tied using a Trimble R7/R8 RTK GPS.

Location and comments

Compass Declination

Surveyors Seal

RECEIVED BY:  
Umatilla County Surveyor  
 Date: 11-05  
 Rec'd By: KK  
 No. 05-198-C

Firm / Agency  
 Witness Tree Surveying  
 Address  
 P.O. Box G  
 Pilot Rock, Or. 97868  
 Party Chief  
 Stephen K, Haddock

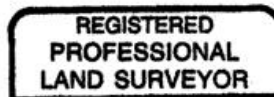

*Stephen K. Haddock*

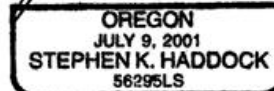

RENEWAL DATE 6-30-07