

OREGON CORNER REFORMATION FORM

COUNTY: Umatilla DATE: 05/27/97

CORNER DESIGNATION: T-5, The East Quarter Corner of Section 30, T4N., R35E., W.M.

PREVIOUS RENEWALS/SURVEYS, ETC.: Corner established by Wm. H. Odell, GLO Contract No. 114, dated July 2, 1866. Notes state: Set post Cor. for 1/4 Secs.; drove charred stake, dug pits and raised mound as per instructions. Corner re-established by Z.F. Moody, GLO Contract No. 164, dated October 4, 1871. Notes state: Set post and made mound of earth for 1/4 Sec. Cor. Corner re-established by Jas. P. Currin and Jas. E. Noland, Under Special Contract, dated May 4, 1887. Notes state: Set post, 3 ft. long, 3 ins. squ., 24 ins. in the ground marked 1/4 S. on W. face, dug pits, 8 x 18 x 12 ins., N. & S. of stake, 5 1/2 ft. dist., raised mound of earth, 1 1/2 ft. high, 3 1/2 ft. base around it.

MONUMENT AND ACCESSORIES FOUND: None. After verification by survey measurement, corner was re-established at an ancient fence corner with fence lines extending West and North.

MONUMENT MARKING DETAIL:

T4N R35E  
1  
4  
S30 | S29  
1997  
PLS 1106

MONUMENT SET:

Set a 2 1/2" brass cap on a 1" x 30" galvanized iron pipe flush with the ground, cap marked as shown in Monument Marking Detail. Accessories:

A 5/8" x 24" iron rod with a yellow plastic cap marked "OR PLS 1106, WA PLS 17372", bears N 30° E, 17.8 feet.

A 5/8" x 24" iron rod with a yellow plastic cap marked "OR PLS 1106, WA PLS 17372", bears S 67° E, 12.1 feet, steel fence post set nearby with witness sign attached.

A 5/8" x 24" iron rod with a yellow plastic cap marked "OR PLS 1106, WA PLS 17372", bears S 53° W, 10.1 feet.

A 5/8" x 24" iron rod with a yellow plastic cap marked "OR PLS 1106, WA PLS 17372", bears N 37° W, 19.9 feet.

Iron rods have bearing object tags attached.

A steel fence post with witness sign attached, 5 feet North of brass cap.

LOCATION & COMMENTS: Corner is located at a fence corner with fences extending North and West.

COMPASS DECLINATION: 18° East

Surveyor's Seal

Witnesses: Kelly Snively  
Jason Wells

OREGON STATE PLANE NORTH CO-ORDINATE FOR CORNER, NAD 83(91), INT. FEET:

N: 783155.11  
E: 8717781.58

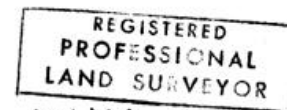

*William R. Wells*

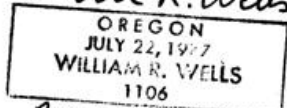

*Renews 6-30-98*