

OREGON CORNER RESTORATION FORM

COUNTY: Umatilla DATE: 02/21/08

CORNER DESIGNATION: P-9, the West One-Quarter Corner of Section 21, T4N, R32E, W.M..

PREVIOUS RENEWALS/SURVEYS ETC.: Corner was originally established by Odell and Lewis, under Contract No. 110, dated May 5, 1865. Original notes state: "Set 1/4 Sec. Post on side hill sloping to the North". County Road No. 272 notes, dated August 18, 1886, by J.C Arnold, County Surveyor, do not state whether the corner was recovered.

MONUMENT AND ACCESSORIES FOUND: None. The corner point falls in the center of County Road No. 851, with a field line extending East.

MONUMENT MARKING DETAIL:

T2N R33E
1/4
S20 | S21
2008
PLS 1106

MONUMENT SET:

After verification by survey, accepted the intersection of the centerline of County Road No. 851 and a field line and berm extending East. The road has been widened out a few feet on the East side for Tim Hawkins house.

At the re-established corner point, set a 2 3/8" brass cap on 1 1/4" by 30" galvanized iron pipe with the cap buried 12" below the gravel road surface. Cap is marked as shown on "Monument Marking Detail".

New Accessories:

A 5/8" by 24" rebar, with red plastic cap marked "OR PLS 1106 WA PLS 17372" bears South 84° East., 27.8'. Wired "bearing object" sign to the rebar.

A "magnail" in the asphalt driveway pavement of Tim Hawkins driveway bears South 10° East., 119.0'. Magnail is located about 2 feet North of the juniper landscaping on the South side of Tim Hawkins North driveway.

A pink "Deep-1" magnet, buried 20" below road ditch line on West side of road, bears South 20 1/2° West., 36.0 feet.

A orange "Deep-1" magnet, buried 20" below road ditch line on West side of road, bears North 15° West., 28.0 feet.

Buried bearing object signs with the magnets.

LOCATION AND COMMENTS:

Corner falls 9 feet East of the West edge of County Road, with a field line extending East. Tim Hawkins house bears Southeast, about 250 feet from corner point.

FIRM: William R. Wells, PLS
P.O. Box 1696
Pendleton, OR 97801

COMPASS DECLINATION: 18° East

Surveyor's Seal

Witnesses: Jason Wells, LSIT

W4N32P9

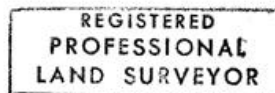

William R. Wells

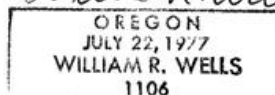

renews 6-30-08

08-51-B