

# OREGON CORNER RESTORATION FORM

SECTION 29 TOWNSHIP 4 NORTH RANGE 29 EAST R-7

COUNTY : UMATILLA DATE 01-2002

CORNER DESIGNATION

NORTH 1/4 CORNER

- CONDITION REPORT ONLY
- NOT FOUND
- RENEWED
- UNCOVERED
- SURVEYED IN
- REFERENCED

PREVIOUS RENEWALS / SURVEYS, ETC.

ORIGINALLY SURVEYED BY DAVENPORT IN 1861 #101. HE SET A POST IN MOUND WITH CHARRED STAKE.

SOMEONE (POSSIBLY W. HARRIS CO.) SET B.C. & B.C. W.C. 1973

BY SINGLE PROPORTION I SET 5/8"X30" REBAR WITH 2" ALUMINUM CAP STAMPED AS BELOW SEE MY 1994-1 COUNTY PUBLIC MONUMENTATION SURVEY

MONUMENTS AND ACCESSORIES FOUND: CONDITION AND SOURCE

FOUND 5/8" IRON REBAR WITH 2" ALUMINUM CAP STAMPED AS BELOW FROM WHICH:

- A 2 1/2" BRASS CAP 1/4 COR. (1973) BEARS S 78°02'11" E 35.35 FEET.
- A 2 1/2" BRASS CAP WITNESS COR. (1973) BEARS S 38°11'40" E 51.13 FEET.

MONUMENT DETAIL

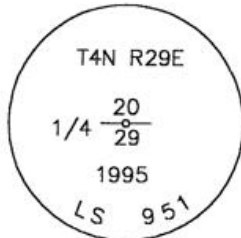

NAD 83/91  
OREGON STATE PLANE  
INTERNATIONAL FEET  
782512.1007  
8529701.8120

SKETCH

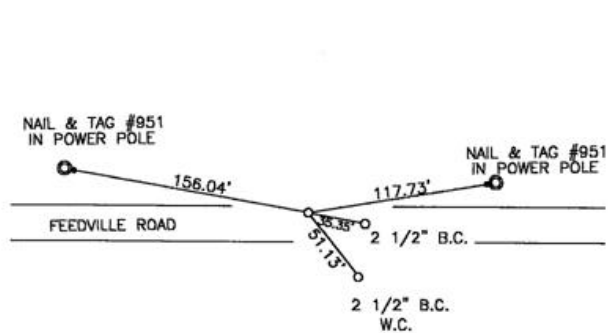

MONUMENT SET ( PROCEDURES AND DESCRIPTION )

NA

NEW ACCESSORIES FROM WHICH

- AN ALUMINUM TAG #951 IN A POWER POLE BEARS N 80°52'56" E 117.30 FEET
- AN ALUMINUM TAG #951 IN A POWER POLE BEARS N 80°12'11" W 156.04 FEET

**RECEIVED BY**

Umatilla County Surveyor

Date 2-02

Rec'd By KK

No. 02-48-g

LOCATION AND COMMENTS

FROM THE INTERSECTION OF EDWARDS ROAD & FEEDVILLE ROAD, GO WEST ON FEEDVILLE 1/2 MILE TO CORNER.

COMPASS DEC.

FIRM/AGENCY  
EDWARDS SURVEYING  
P.O. BOX 763  
HERMISTON, OREGON 97838

PARTY CHIEF  
CURTIS FAVOREL  
NOTES

WITNESS  
WALT MUNDELL

SURVEYOR'S SEAL

REGISTERED  
PROFESSIONAL  
LAND SURVEYOR

*G. Dennis Edwards*

OREGON  
JULY 16, 1971  
G. DENNIS EDWARDS  
9 5 1  
RENEWS 12/31/2003