

**OREGON CORNER RESTORATION FORM**

SECTION: 11 TOWNSHIP: 4N

RANGE: 29E

E-21

COUNTY: UMATILLA

DATE: 9/2013

**CORNER DESIGNATION**

NE COR.

- CONDITION REPORT ONLY**
- NOT FOUND**
- RENEWED**
- UNRECORDED**
- SURVEYED IN**
- REFERENCED OUT**

**PREVIOUS RENEWALS/SURVEYS ETC.**

Originally surveyed by Davenport under Contract #101 in 1861. He set a post in mound with charred stake.

In 1934 the U.S. Department of Agriculture must have done a survey for which I could find no record.

**MONUMENTS AND ACCESSORIES FOUND: CONDITON AND SOURCE**

Found a 3" iron pipe with a 3" brass cap stamped as below with 1934 U.S. Dep. of Agri. It lies in a fence corner and the numbers are orientated to the Southeast which indicates it was probably moved from its original location. I did not use.

**MONUMENT DETAIL**

T4N R29E  
 S2 | S1  
 S11 | S12  
 2013  
 LS 951

NAD 83/91  
 OREGON STATE PLANE  
 INTERNATIONAL FEET  
 798847.63  
 8547908.05

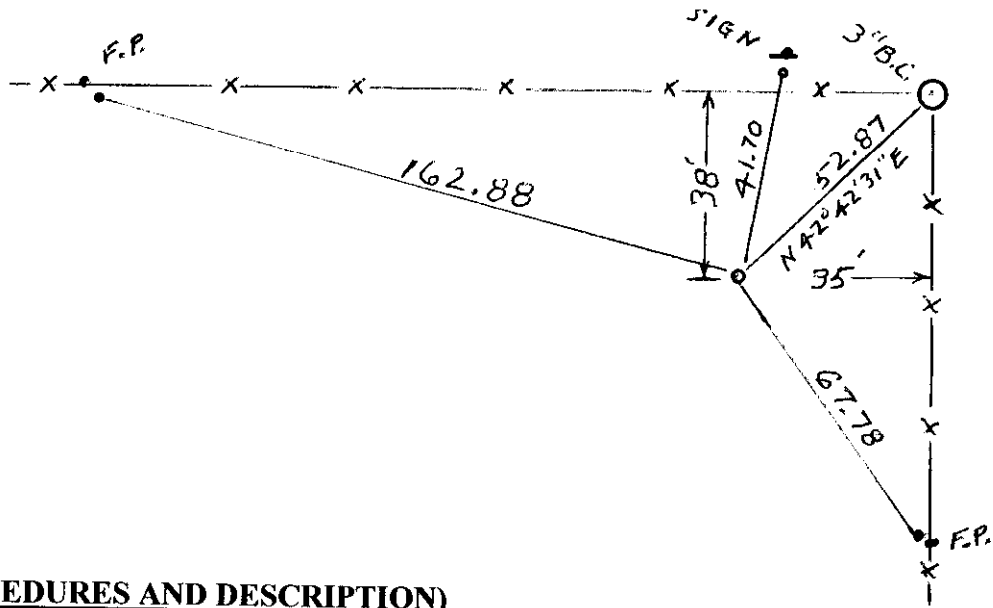

**MONUMENT SET (PROCEDURES AND DESCRIPTION)**

By double proportion I set a 1" x 15" iron pipe with a 2 1/2" brass cap 24" below the surface of a cultivated field stamped as above and poured concrete around it.

**NEW ACCESSORIES FROM WHICH**

- A 3" Iron Pipe with a 3" brass cap stamped 1934 U.S. Dep. of Agri. bears N 42° 42' 31" E 52.87'
- A 5/8" x 30" Iron Rebar with plastic cap #951 bears N 14° 19' 10" E 41.70'
- A 5/8" x 30" Iron Rebar with plastic cap #951 bears N 76° 44' 34" W 162.88'
- A 5/8" x 30" Iron Rebar with plastic cap #951 bears S 30° 16' 34" E 67.78'

**LOCATION AND COMMENTS**

From the South access gate of Cold Springs Wildlife Refuge which is 0.25 mile north of the NE corner of Loop Road go East 0.5 mile along a fence to the corner.

SURVEYOR'S SEAL

FIRM: EDWARDS SURVEYING LLC  
 PO BOX 763 - HERMISTON OR 97838

PARTY CHIEF: G. EDWARDS  
 WITNESS: R. FRITZ

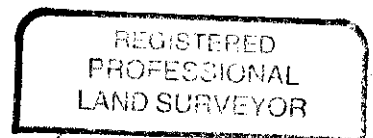

*G. Dennis Edwards*

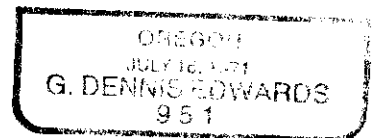

RENEWS 12/31/13

13-532-C