

OREGON CORNER RESTORATION FORM

SECTION: 10 TOWNSHIP: 4N RANGE: 29E E-17

COUNTY: UMATILLA DATE: 9/2013

CORNER DESIGNATION

NE COR.

- CONDITION REPORT ONLY**
- NOT FOUND**
- RENEWED**
- UNRECORDED**
- SURVEYED IN**
- REFERENCED OUT**

PREVIOUS RENEWALS/SURVEYS ETC.

Originally surveyed by Davenport under Contract #101 in 1861. He set a post in mound with charred stake.

In survey #06-475-B Brit Primm computed the location of this corner by double proportion.

On partition Plat 2011 -7 and my survey #11-95-B, I used Primms survey ties to the NW and SE corners of section 10 to compute the location of this corner and to set the Center 1/4.

MONUMENTS AND ACCESSORIES FOUND: CONDITON AND SOURCE

Nothing found.

MONUMENT DETAIL

T4N R29E
S3 | S2
S10 | S11
2013
LS 951

NAD 83/91
OREGON STATE PLANE
INTERNATIONAL FEET
798747.16
8542639.53

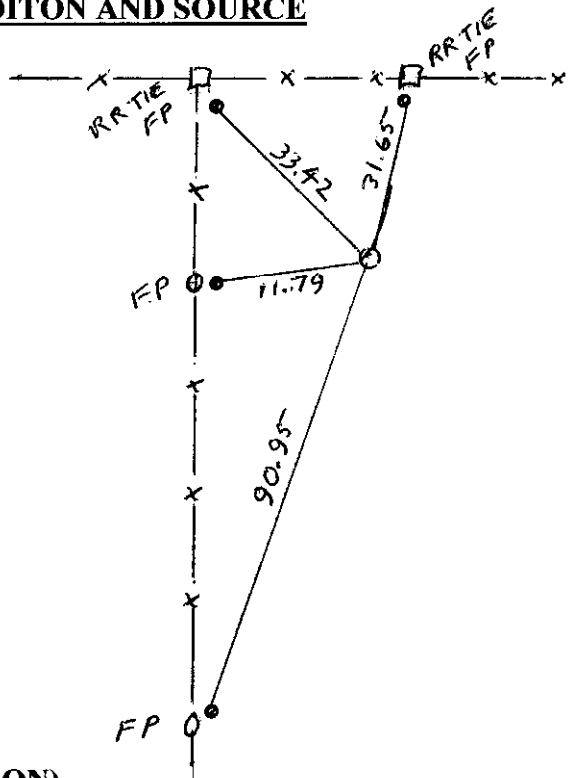

MONUMENT SET (PROCEDURES AND DESCRIPTION)

At the computed location of this corner on my Partition Plat 2011-07 (which was based on the computed location on B. Primm's 2006 survey #06-475-B) I set a 1"x15" iron pipe with a 2 1/2" brass cap stamped as above 24" below the surface of a cultivated field and poured concrete around.

NEW ACCESSORIES FROM WHICH

- A 5/8" x 30" Iron Rebar with plastic cap #951 bears S 7° 24' 06" W 90.95'
- A 5/8" x 30" Iron Rebar with plastic cap #951 bears S 87° 35' 23" W 11.79'
- A 5/8" x 30" Iron Rebar with plastic cap #951 bears N 22° 42' 55" W 33.42'
- A 5/8" x 30" Iron Rebar with plastic cap #951 bears N 6° 09' 47" E 31.65'

LOCATION AND COMMENTS

From the most northeasterly corner of Loop Road go West 0.50 mile to a fence corner. Then go North along a fence line 0.25 mile to the corner at a fence corner

SURVEYOR'S SEAL

FIRM: EDWARDS SURVEYING LLC
PO BOX 763 - HERMISTON OR 97838

PARTY CHIEF: G. EDWARDS
WITNESS: R. FRITZ

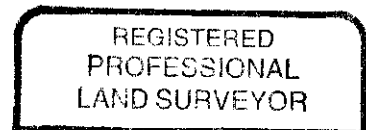

G. Dennis Edwards

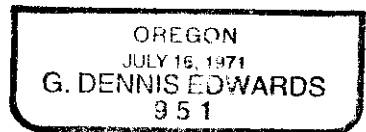

RENEWS 12/31/13

13-532-C