

CERTIFIED RECORD OF LAND CORNER MONUMENTATION

History of original corner establishment:

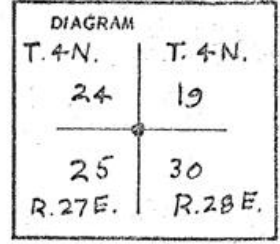

R-25

Description of corner evidence found:

Fnd. 2" I. Pipe set by D. Staebler in asphalt, checked distances to r.p.'s he set on power poles.

Description of monument and accessories established to perpetuate the original location of this corner

Established Brass Cap W.C.'s

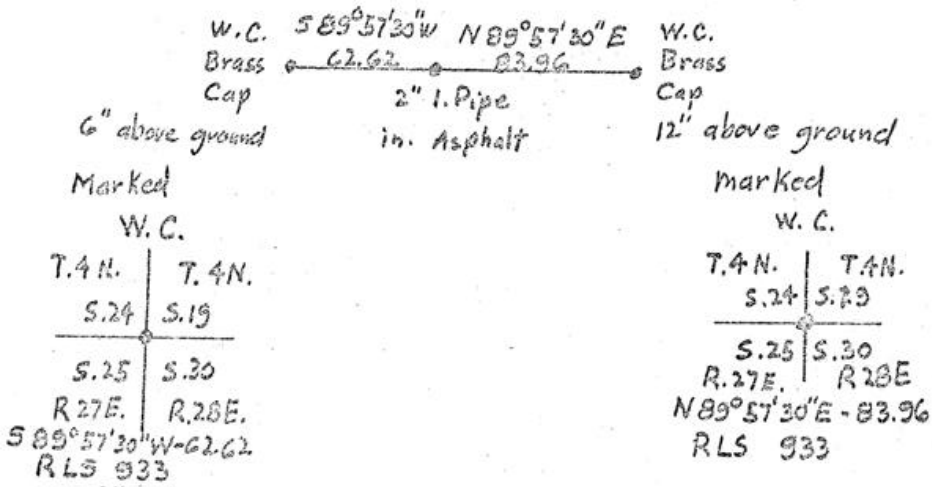

Office of..... County of.....  
 State of....., I hereby certify that the within Instrument was filed in this office  
 for record on the ..... day of .....; 19....., at..... o'clock .....m., (signed)  
 (COUNTY OFFICIAL) by (DEPUTY)

CERTIFIED RECORD OF LAND CORNER MONUMENTATION

History of original corner establishment:

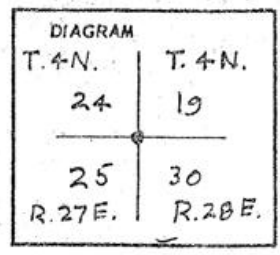

R-25

Description of corner evidence found:

Fnd. 2" I. Pipe set by D. Staebler in asphalt, checked distances to r.p.'s he set on power poles.

Description of monument and accessories I established to perpetuate the original location of this corner

Established Brass Cap W.C.'s

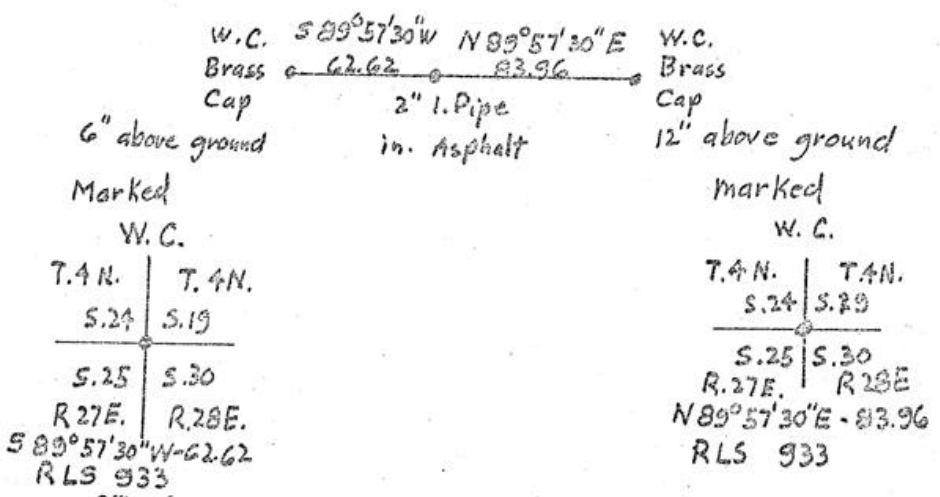

Office of ..... County of .....

State of ....., I hereby certify that the within instrument was filed in this office for record on the ..... day of ....., 19....., at ..... o'clock ..... m., (signed)

..... by ..... (COUNTY OFFICIAL) ..... (DEPUTY)