

OREGON CORNER RESTORATION FORM

SECTION 23 TOWNSHIP 4N RANGE 28 E

N-19

COUNTY: UMATILLA DATE 12/91

CORNER DESIGNATION

North 1/4 Corner

- CONDITION REPORT ONLY
- NOT FOUND
- RENEWED
- UNRECORDED
- SURVEYED IN
- REFERENCED OUT

PREVIOUS RENEWALS/SURVEYS, ETC.

Originally surveyed in 1860 by Taft under Contract #93. He set post in mound with trench, made pits and deposited a pint of charcoal. Kimbrell surveyed to this corner in County Survey #175 in 1903. Said he found original stake and charcoal.

MONUMENTS & ACCESSORIES FOUND: Condition and Source

Found Basalt stone 8" x 10" x 15" scribed X 1/4 undisturbed 1 foot deep. Read from North. Could be from Kimbrell Survey.

MONUMENT DETAIL

SKETCH

T4N R28E  
 14  
 1/4 23  
 1991  
 LS 951

MONUMENT SET (PROCEDURES AND DESCRIPTION)

1 set a 2 3/8" Brass Cap, stamped as above, on 1" x 30" Iron pipe in place of stone 0.1 ft. above ground. Set found stone South and read from S. Drove steel fence post 3 feet North, raised mound, dug 3 ft. trench around it.

NEW ACCESSORIES From which

- A found 3/4" Bolt with 1" square nut on top Bears N 61° 33' 38" E 6.07 feet.
- An Alum. tag #951 in 0.8 ft. fence post Bears N 2° 14' 20" E 34.13 feet with Bearing Object sign attached.
- An Alum. tag #951 in Power pole Bears S 43° 55' 50" W 113.53 feet with Bearing Object sign attached.
- A 2 3/8" Brass Cap on 1" x 30" Iron pipe, stamped W.C. LS 951 Bears S 0° 00' 50" W 188.17 feet. Attached Witness and Bearing Object signs to RR tie fence post.

LOCATION & COMMENTS

From intersection of Feed Canal and U.S. Hwy. #395, go south-westerly along North side of canal 0.4 mile to fence line. Corner lies North 60 ± feet of canal.

COMPASS DEC.

FIRM EDWARDS SURVEYING  
P.O. BOX 763, HERMISTON,  
OREGON, 97838

PARTY CHIEF D. EDWARDS  
NOTES

WITNESS S. BENEFIT

SURVEYOR'S SEAL

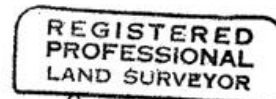

*G. Dennis Edwards*

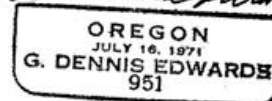

RECEIVED BY

Umatilla County Surveyor

Date 4-92

Rec'd By RF

No. 92-45-0