

OREGON CORNER RESTORATION FORM

SECTION 12 TOWNSHIP 4 NORTH RANGE 27 EAST G-25

COUNTY : UMATILLA DATE 10-2002

CORNER DESIGNATION

EAST 1/4 CORNER

CONDITION REPORT ONLY
 NOT FOUND
 RENEWED
 UNCOVERED
 SURVEYED IN
 REFERENCED

PREVIOUS RENEWALS / SURVEYS, ETC.

ORIGINAL SURVEY BY HAFT IN 1860.
DEPENDENT RESURVEY BY GOULD IN 1941.
SURVEY : PARTITION PLAT # 1992-29, EDWARDS SET 2 1/2" BRASS CAP
STAMPED AS BELOW, FROM GOULD W.C. 16.5 FEET WEST.

MONUMENTS AND ACCESSORIES FOUND: CONDITION AND SOURCE

FOUND 5/8" IRON REBAR OVER EDWARDS' BRASS CAP.
FOUND 2 1/2" BRASS CAP W.C. BY GOULD IN 1941 S 89°20' W 16.50 FEET.
FOUND 3 3/4" B.C. B.M. EL. 546.68 BEARS S 88°54' E 27.70 FEET.
AN ALUMINUM TAG #951 ON A POWER POLE BEARS S 83°45' E 24.13 FEET.

MONUMENT DETAIL

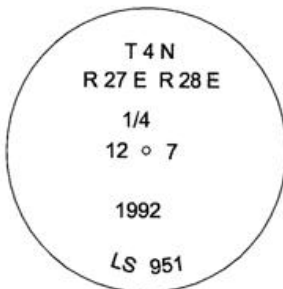

NAD 83/91
OREGON STATE PLANE
INTERNATIONAL FEET
795380.6908
8489456.7619

SKETCH

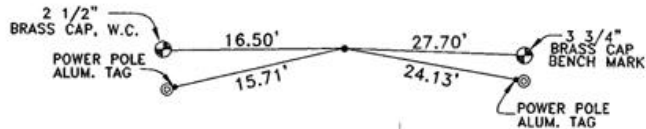

MONUMENT SET (PROCEDURES AND DESCRIPTION)

NA

NEW ACCESSORIES FROM WHICH

AN ALUMINUM TAG ON A POWER POLE #951 BEARS S 77° 09'30" W 15.71 FEET.

LOCATION AND COMMENTS

FROM THE INTERSECTION OF BRIDGE ROAD AND WALKER ROAD, GO NORTH ALONG WALKER ROAD ONE HALF MILE TO CORNER.

COMPASS DEC.

FIRM/AGENCY
EDWARDS SURVEYING
P.O. BOX 763
HERMISTON, OREGON 97838

PARTY CHIEF
CURTIS FAVOREL

NOTES

WITNESS
RICK SMITH

SURVEYOR'S SEAL

REGISTERED
PROFESSIONAL
LAND SURVEYOR

G. Dennis Edwards

OREGON
JULY 16, 1971
G. DENNIS EDWARDS
9 5 1
RENEWS 12/31/2003

03-50-9