

# OREGON CORNER RESTORATION FORM

SECTION 2,3,10,11 TOWNSHIP 4 NORTH RANGE 28 EAST E-17  
COUNTY : UMATILLA DATE AUG/21

CORNER DESIGNATION  
SECTION CORNER

- CONDITION REPORT ONLY
- NOT FOUND
- RENEWED
- UNCOVERED
- SURVEYED IN
- REFERENCED

PREVIOUS RENEWALS / SURVEYS, ETC.

SURVEYED IN 1860 BY HAFT. LS 2360 RESET THE MONUMENT IN 2001. SEE PARTITION PLAT 2001-40

MONUMENTS AND ACCESSORIES FOUND: CONDITION AND SOURCE

I RECOVERED THE CORNER AND COMPARED ITS LOCATION WITH DUAL MONUMENTATION IN THE AREA AS REQUESTED. PLEASE REFER TO TO RECORD OF SURVEY THAT WAS RECORDED ALONG WITH THIS CORNER RESTORATION FORM FOR MY ANALYSES. THE ACCESSORIES FOR THE CORNER WERE NOT RECOVERED DURING THIS SURVEY DUE TO THE FACT IT HAD NO BEARING ON THE CORNERS LOCATION. PLEASE REFER TO SURVEY NUMBER 19-080-C AND THE CORNER RESTORATION FORMS RECORDED WITH SAID RECORD OF SURVEY FOR ACCESSORY INFORMATION.

MONUMENT DETAIL

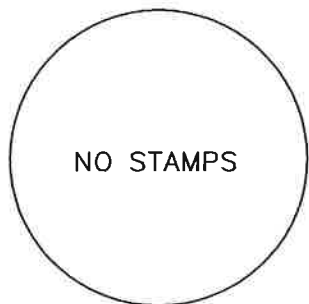

N.T.S

NAD 83/91  
OREGON STATE PLANE  
INTERNATIONAL FEET

798163.68  
8510376.84

SKETCH

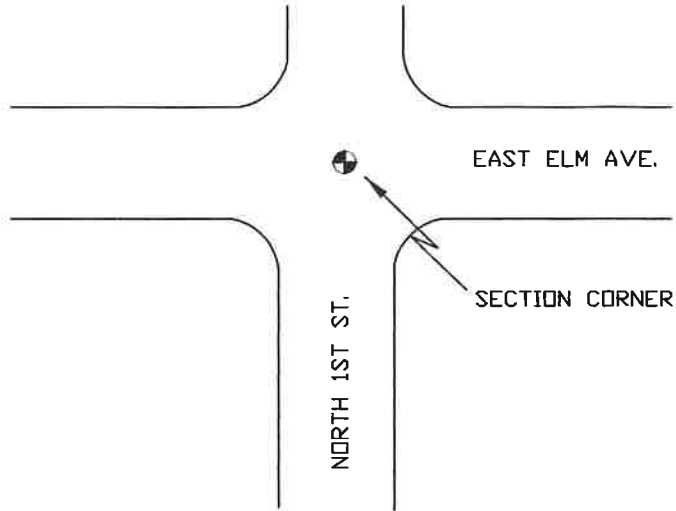

MONUMENT SET ( PROCEDURES AND DESCRIPTION )

NEW ACCESSORIES FROM WHICH

I RECOVERED THE CORNER AND COMPARED ITS LOCATION WITH DUAL MONUMENTATION IN THE AREA AS REQUESTED. PLEASE REFER TO TO RECORD OF SURVEY THAT WAS RECORDED ALONG WITH THIS CORNER RESTORATION FORM FOR MY ANALYSES. THE ACCESSORIES FOR THE CORNER WERE NOT RECOVERED DURING THIS SURVEY DUE TO THE FACT IT HAD NO BEARING ON THE CORNERS LOCATION. PLEASE REFER TO SURVEY NUMBER 19-080-C AND THE CORNER RESTORATION FORMS RECORDED WITH SAID RECORD OF SURVEY FOR ACCESSORY INFORMATION.

LOCATION AND COMMENTS

CORNER IS AT THE INTERSECTION OF EAST ELM AVENUE AND NORTH 1ST STREET.

FIRM/AGENCY

PRIMM LAND SURVEYING, INC.  
P.O. BOX 1322  
HERMISTON, OREGON 97838

LAND SURVEYOR

BRIT L. PRIMM

WITNESS

KEITH P. PRIMM

SURVEYOR'S SEAL

REGISTERED  
PROFESSIONAL  
LAND SURVEYOR

OREGON  
JULY 13, 1999  
BRIT L. PRIMM  
48509

EXPIRATION DATE: 12/31/22