

Index

File No. 2-25

T 2S 3S R. 34E 35E

Merid. Willamette

CORNER RECORD (SEARCH)

(Ref. FSM 7151.4)

Tract or Survey No. \_\_\_\_\_

Cor. No. \_\_\_\_\_ Sec. \_\_\_\_\_

R.D. La Grande County Union

N.F. Wallowa-Whitman State Oregon

CORNER DIAGRAM

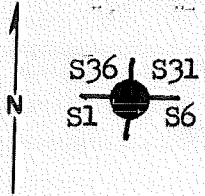

DESCRIBE-CORNER MONUMENT-FOUND

Found 30x20x12 inch stone, firmly set and clearly notched on 4 sides.

DESCRIBE BEARING TREES OR OTHER OFFICIAL ACCESSORIES FOUND

From which:--A 19" pine (dead) bears N74°E, 47.9 ft. faint scribing. A 16" pine bears S40°E, 33.9 ft., visible scribing. A 24" pine bears S15°W, 37.3 ft. with grown over blazes. A fir stump bears N50°W, 198.2 ft.

PHOTO IDENTIFICATION DATA

Photo No. EWD-17-231

Filed At. La Grande

Object Ident. Direct

Ident. By B. Barbour RLS

*Signature*

PLANE COORDINATE POSITION DATA

State \_\_\_\_\_ Zone \_\_\_\_\_

X \_\_\_\_\_

Y \_\_\_\_\_

Estab. By \_\_\_\_\_

*Agency*

*Signature*  
Barry B Barbour

Title  
P.L.S.

Division

Headquarters  
Sumpter

Date  
10-15-80

7100-52 (3.68)

### CORNER RECORD (PERPETUATION)

**MONUMENT: DESCRIBE NEW MONUMENT SET, OR WORK DONE TO PRESERVE EXISTING MONUMENT**

At the center of above described stone set 2½" X 30" galvanized pipe and brass cap marked; Set pipe 12" in the ground and mound of stone around to cap. Placed marked stone in mound.

T2S  
 R34E R35E  
 S36 | S31  
 S1 —+— S6  
 T3S  
 OR PLS 1051  
 1980

**ACCESSORIES: DESCRIBE NEW BT'S WITNESS OBJECTS ETC. ESTABLISHED, OR WORK DONE TO PRESERVE EXISTING EVIDENCE**

From which by magnetic declination of N20°E; A 14" pine bears N59°E, 86.3 ft. scribed T2SR35ES31 BT. A 12" pine bears N75°W, 29.3 ft. scribed T2SR34ES36 BT. 01 BTs are tagged. Painted blazes red and 6" red band around. Placed 54-3s, 54-4s and brass washers stamped PLS 1051 on BTs. Placed 54-2 and 54-4 on steel fence post 5' north and 54-2 on steel fence post 5' west of the corner.

Work Done By B. B. Barbour Title P.L.S. Date 10-15-80 State Registration No. OR 1051  
 or Agency

Certified Cor. Record Prepared? Yes  No  Filed At: Union County Surveyor's Date

**REMARKS**

Witnesses: Daniel Rowland  
 Doug Moser

Index File No. 2 25  
T 25 R. 34E  
Merid. Will

CORNER RECORD (SEARCH)

R.D. LaGrande County Union Tract or Survey No. \_\_\_\_\_ Cor. No. \_\_\_\_\_  
N.F. W-W State Oregon

CORNER DIAGRAM

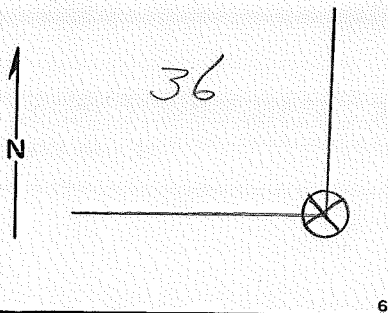

DESCRIBE CORNER MONUMENT FOUND 1

Basalt Stone, no marking visible because of snow and ice.

DESCRIBE BEARING TREES OR OTHER OFFICIAL ACCESSORIES FOUND 2

Sec. 31 - D.F. 18" Shag  
Sec. 6 - P.P. 16" Live  
Sec. 1 - P.P. 24" Live

PHOTO IDENTIFICATION DATA 6

Photo No. \_\_\_\_\_  
Filed At. \_\_\_\_\_  
Object Ident. \_\_\_\_\_  
Ident. By \_\_\_\_\_  
*Signature*

DESCRIBE CORNER LOCATION RELATIVE TO NEAR-BY FEATURES, ALSO HOW TO REACH CORNER 3

PLANE COORDINATE POSITION DATA 7

State \_\_\_\_\_ Zone \_\_\_\_\_  
X \_\_\_\_\_  
Y \_\_\_\_\_  
Estab. By \_\_\_\_\_  
*Agency*

Signature \_\_\_\_\_ Title \_\_\_\_\_ Division \_\_\_\_\_ Headquarters \_\_\_\_\_ Date \_\_\_\_\_ 4

Dave Dahlstrom CET LaGrande 2-6-80

CORNER RECORD (PERPETUATION)

MONUMENT: DESCRIBE NEW MONUMENT SET, OR WORK DONE TO PRESERVE EXISTING MONUMENT

ACCESSORIES DESCRIBE NEW BT'S WITNESS OBJECTS ETC. ESTABLISHED, OR WORK DONE TO PRESERVE EXISTING EVIDENCE

Work Done By \_\_\_\_\_ Title \_\_\_\_\_ Date \_\_\_\_\_ State Registration No. or Agency \_\_\_\_\_  
Certified Cor. Record Prepared? Yes No Filed At: \_\_\_\_\_ Date \_\_\_\_\_

REMARKS

Index File No. T. R. M. Tract or Surv. No. Cor.

LAND CORNER RECORD

1. T 25 R 34E No. 225 Cor. Sec Mer. W State 36 (Rectangular) N. F. 16 Dist. 6

2. Corner Status

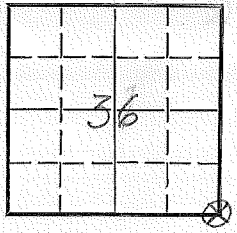

3. Original Description \_\_\_\_\_ Vol. \_\_\_\_\_ Page \_\_\_\_\_ Where Recorded \_\_\_\_\_

4. Description of Corners: Set a volcanic stone, 20 x 20 x 12 ins., 12 ins in the ground, to bedrock 9 ins. in a mound of stone for cor. of Tps. 2 & 3 S. Rs. 34 & 35 E., from which:  
A fir, 16 ins. diam. brs. N. 72° 15' E. 72 Lks. dist.  
A fir, 18 ins. diam. brs. S. 42° 30' E. 50 Lks. dist.  
A fir, 20 ins. diam. brs. S. 14° 30' W. 56 Lks. dist.  
A fir 24 ins. diam. brs. N. 50° W 300 Lks dist.

5. Investigation Notes:

Bearing trees in Sec. 1-6-36

7. Photo Identification  
Photo No. \_\_\_\_\_  
Ident. By: \_\_\_\_\_

8. Plane Coordinate Position Data  
State \_\_\_\_\_ Zone \_\_\_\_\_  
X \_\_\_\_\_  
Y \_\_\_\_\_  
Estab. By \_\_\_\_\_  
Field Book No. \_\_\_\_\_  
Where Filed \_\_\_\_\_

9. Evaluation  
Authentic yes  
Needs Verif. \_\_\_\_\_ Monument NO  
Re-estab. X Survey \_\_\_\_\_  
Land Status \_\_\_\_\_

6. Signed Palmer Title T.S.O. Date 7/6/2

# PERPETUATION RECORD

10. Monument:

11. Accessories

		Field Book _____	Page _____
12. Set By _____	Title _____	13. Recorded By _____	Volume _____
License _____	Agency _____	(Agency)	Page _____
Date _____		(Date) _____	(City) _____
		(County) _____	(State) _____

14. Remarks:

USDA FOREST SERVICE

Index  
 File No. A-25 Z-1 35E

CORNER RECORD (SEARCH)

(Ref: FSM 7151.4)

Tract or

Survey No. \_\_\_\_\_

Cor. Sec.  
 No. \_\_\_\_\_

T. 25 R. 34E R.D. La Grande County Union

Merid. Willamette N.F. Wallowa-Whitman State Oregon

CORNER DIAGRAM

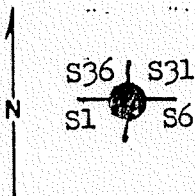

DESCRIBE CORNER MONUMENT FOUND

Found 30x20x12 inch stone, firmly set and clearly notched on 4 sides.

DESCRIBE BEARING TREES OR OTHER OFFICIAL ACCESSORIES FOUND

From which: A 19" pine (lead) bears N74°E, 47.9 ft. faint scribing. A 16" pine bears S40°E, 33.9 ft., visible scribing. A 24" pine bears S15°W, 37.3 ft. with grown over blazes. A fir stump bears N50°W, 198.2 ft.

PHOTO IDENTIFICATION DATA

Photo No. EWD-17-231

Filed At. La Grande

Object Ident. Dist

Ident. By B. Barlow RLS

*Signature*

DESCRIBE CORNER LOCATION RELATIVE TO NEAR-BY FEATURES, ALSO HOW TO REACH CORNER

PLANE COORDINATE POSITION DATA

State \_\_\_\_\_ Zone \_\_\_\_\_

X \_\_\_\_\_

Y \_\_\_\_\_

Estab. By \_\_\_\_\_

*Agency*

Signature

Title

Division

Headquarters

Date

7100-52 (3 68)

CORNER RECORD (PERPETUATION)

UMENT. DESCRIBE NEW MONUMENT SET, OR WORK DONE TO PRESERVE EXISTING MONUMENT

At the center of above described stone set 2 1/2" X 30"  
galvanized pipe and brass cap marked: Set pipe 12"  
in the ground and mound of stone around to cap.  
Placed marked stone in mound.

T2S  
R3-E R35E  
S36 | S31  
S1 | S6  
T3S  
OR PLS 1051  
1080

ESSORIES DESCRIBE NEW BT'S WITNESS OBJECTS ETC. ESTABLISHED, OR WORK DONE TO PRESERVE EXISTING EVIDENCE

From which by magnetic declination of N20°E; A 14" pine bears N59°E, 86.3 ft.  
scribed T2SR35ES31 BT. A 12" pine bears N75°W, 29.3 ft. scribed T2SR34ES36 T.  
Ol. BTs are tagged. Painted blazes red and 6" red band around. Placed 54-3s,  
54-4s and brass washers stamped PLS 1051 on BTs. Placed 54-2 and 54-4 on steel  
fence post 5' north and 54-2 on steel fence post 5' west of the corner.

10

Work Done By B. B. Barbour Title P.L.S. Date 10-15-80 State Registration No. OR 1051  
or Agency

ified Cor. Record Prepared? Yes  No Filed At: Union County Surveyor's Date

11

REMARKS

Witnesses: Daniel Rowland  
Doug Moser