

Index

File No. Z-23

T 2S 3S R. 34E

Merid. Willamette

CORNER RECORD (SEARCH)

(Ref. FSM 7151.4)

R.D. La Grande

N.F. Wallowa-Whitman

County Union

State Oregon

Tract or

Survey No. _____

Cor.

No. 1/4

CORNER DIAGRAM

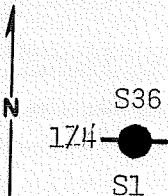

DESCRIBE CORNER MONUMENT FOUND

Corner falls in center of old road and no trace of record stone could be found.

DESCRIBE BEARING TREES OR OTHER OFFICIAL ACCESSORIES FOUND

Found 30" pine partially opened blaze "4S" visible. Measured S28°E, 25.7 ft. Found 45" pine with grown over blazes, S06°E, 47.8 ft.

PHOTO IDENTIFICATION DATA

Photo No. EVD-17-231

Filed At. La Grande

Object Ident. D need

Ident. By B. Barbour RLS

Signature

PLANE COORDINATE POSITION DATA

State _____ Zone _____

X _____

Y _____

Estab. By _____

Agency

DESCRIBE CORNER LOCATION RELATIVE TO NEAR-BY FEATURES, ALSO HOW TO REACH CORNER

Signature

Barry B. Barbour

Title

P, L, S,

Division

Headquarters

Sumpter

Date

10-20-80

7100-52 (3.69)

CORNER RECORD (PERPETUATION)

MONUMENT: DESCRIBE NEW MONUMENT SET, OR WORK DONE TO PRESERVE EXISTING MONUMENT

T2S R34E
S36

At the above point set 2 1/2" X 30" galvanized pipe and brass cap marked: Set pipe 12" in the ground to bedrock and mound of stone around to cap.

1/4 

S1

OR PLS 1051
1980

ACCESSORIES: DESCRIBE NEW BT's WITNESS OBJECTS ETC. ESTABLISHED, OR WORK DONE TO PRESERVE EXISTING EVIDENCE

Placed 54-3s and 54-4s on BTs, Painted 6" red band around. Placed 54-2 and 54-4 on steel fence post 5' west of the corner,

Work Done By B. B. Barbour Title P.L.S. Date 10-20-80 State Registration No. OR 1051
Or Agency

Certified Cor. Record Prepared? Yes No Filed At: Union County Surveyor's Date

REMARKS

Witnesses: Daniel Rowland
Doug Moser

Index File No. 223

CORNER RECORD (SEARCH)

(Ref. FSM 7151.4)

Tract or Survey No. _____ Cor. No. _____

T. 25 R. 34 E R.D. LaGrande County Union
 Merid. Will N.F. W-U State Oregon

CORNER DIAGRAM

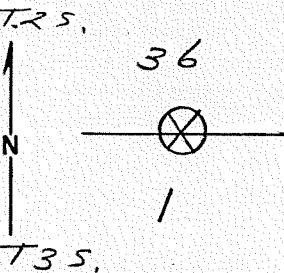

DESCRIBE CORNER MONUMENT FOUND

None

DESCRIBE BEARING TREES OR OTHER OFFICIAL ACCESSORIES FOUND

*Both BT's present
 scribe visible on BT in sec. 36*

PHOTO IDENTIFICATION DATA

Photo No. _____
 Filed At. _____
 Object Ident. _____
 Ident. By _____
Signature

PLANE COORDINATE POSITION DATA

State _____ Zone _____
 X _____
 Y _____
 Estab. By _____
Agency

DESCRIBE CORNER LOCATION RELATIVE TO NEAR-BY FEATURES, ALSO HOW TO REACH CORNER

Signature David L. Dillman Title CET Division LaGrande Headquarters LaGrande Date 2-22-80
 7100-52 (3 68)