

Index

File No. Z-21

CORNER RECORD (SEARCH)

(Ref. FSM 7151.4)

Tract or

Survey No. \_\_\_\_\_

Cor.

No. 2175

T 3S R. 33E

R.D. LAGRANDE

County UNION & UMATILLA

Merid. WILLAMETTE

N.F. WALLWA-WHIT

State OREGON

CORNER DIAGRAM

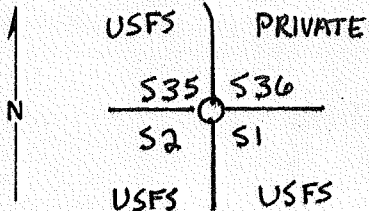

DESCRIBE CORNER MONUMENT FOUND

FOUND STONE 16" X 9" X 7" FIRMLY SET. 5 NOTCHES ON SE CORNER, 1 NOTCH NW CORNER.

DESCRIBE BEARING TREES OR OTHER OFFICIAL ACCESSORIES FOUND

NONE

PHOTO IDENTIFICATION DATA

Photo No. \_\_\_\_\_

Filed At. \_\_\_\_\_

Object Ident. \_\_\_\_\_

Ident. By \_\_\_\_\_

Signature

PLANE COORDINATE POSITION DATA

State \_\_\_\_\_ Zone \_\_\_\_\_

X \_\_\_\_\_

Y \_\_\_\_\_

Estab. By \_\_\_\_\_

Agency

Signature

*B. Skilton*

Title LS 1840

Division

Headquarters

Date 9-83

FS-7100-52 (3/68)

CORNER RECORD (PERPETUATION)

MONUMENT: DESCRIBE NEW MONUMENT SET, OR WORK DONE TO PRESERVE EXISTING MONUMENT

SET 2 1/2" x 31" ALUMINUM PIPE WITH 3/4" ALUMINUM LAP RISING 4",  
 MARKED:

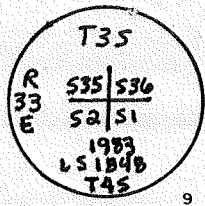

ACCESSORIES: DESCRIBE NEW BT'S WITNESS OBJECTS ETC. ESTABLISHED, OR WORK DONE TO PRESERVE EXISTING EVIDENCE

- 5.0" L.P. BEARS N35°W, 17.0 FT. B&S T35, R33E, 535 BT
- 5.1" L.P. BEARS N60°E, 28.0 FT. B&S T35, R33E, 536 BT
- 5.2" L.P. BEARS S40°W, 9.7 FT. B&S T45, R33E, 52 BT
- 6.0" L.P. BEARS S55°E, 13.1 FT. B&S T45, R33E, 51 BT

Work Done By: B.A. SUTTON Title: SURVEYOR Date: 9-83 State Registration No. or Agency: LS 1848

Certified Cor. Record Prepared? Yes  No  Filed At: UNION CO. SURVEYOR'S OFFICE Date: \_\_\_\_\_

REMARKS

Index File No. 221 T. 35 R. 33E W.M. Tract or Surv. No. Cor. 2175

USDA-FOREST SERVICE

Index File No. 2-21

CORNER RECORD (SEARCH)

(Ref. FSM 7151.4)

Tract or Survey No. \_\_\_\_\_ Cor. No. \_\_\_\_\_

T 55 R. 33 E

R.D. LaGrande County Union-Umatilla Co. line

Merid. Williamette

N. F. Wallows-Whitman State Oregon

CORNER DIAGRAM

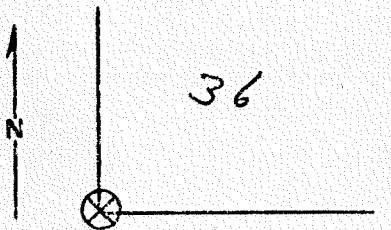

DESCRIBE CORNER MONUMENT FOUND

Basalt Stone 18" x 12" x 6" 10" above ground  
good condition 5 notches on SE edge and one notch on NW edge

DESCRIBE BEARING TREES OR OTHER OFFICIAL ACCESSORIES FOUND

None remain, area has burned probably 80 or 90 year ago.

PHOTO IDENTIFICATION DATA

Photo No. \_\_\_\_\_  
Filed At. \_\_\_\_\_  
Object Ident. \_\_\_\_\_  
Ident. By \_\_\_\_\_  
*Signature*

There are some stump holes which match

PLANE COORDINATE POSITION DATA

State \_\_\_\_\_ Zone \_\_\_\_\_  
X \_\_\_\_\_  
Y \_\_\_\_\_  
Estab. By \_\_\_\_\_  
*Agency*

DESCRIBE CORNER LOCATION RELATIVE TO NEAR-BY FEATURES, ALSO HOW TO REACH CORNER

Signature David A. Dahlstrom Title CET Division \_\_\_\_\_ Headquarters LaGrande Date 10-21-82 7100-52-(3, 68)