

RECORD OF LAND CORNER MONUMENTATION

NORTH 1/4 CORNER SECTION 13, T. 3 S., R. 32 E., W.M.

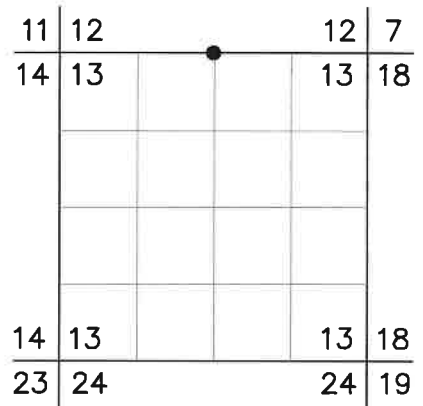

ORIGINALLY ESTABLISHED BY: George S. Pershin, U.S. Deputy Surveyor

CONTRACT NUMBER: 430

CONTRACT DATE: March 23, 1882

ORIGINAL DESCRIPTION:

Set a basalt stone 15 x 14 x 10 ins 10 ins in ground on S. slope for 1/4 sec. cor. marked 1/4 on North face. Mound of stone alongside
 A Pine 42 ins. di. brs. N.45°E 168 lks dist marked 1/4 S., B.T.
 No tree on S. side.

EVIDENCE FOUND: Found stone 15"x14"x10" firmly set 6" in ground, marked 1/4 on north face, in the center of a 2 ft. diameter embedded mound of stone. I searched for, but found no remains of the original bearing tree, possibly due to past fire activity in the area. I accept the position of the marked stone for the corner.

DESCRIPTION OF MONUMENTS AND ACCESSORIES SET AND METHODS USED:

At the corner point, I set a standard USFS 2½"x30" aluminum pipe with attached ¾" aluminum cap 20" in the ground. Built a 2 ft. diameter mound of stone around the monument to top of cap. Cap is marked as shown below.

From which, **I SCRIBE A NEW BEARING TREE:**

- ▶ A ponderosa pine 15" dbh, bears S.75°W., 1.8 ft., marked 1/4S13 in upper blaze and BT in lower blaze.

Also from which, **I SET NEW REFERENCE POINTS:**

- ▶ A 5/8"x 8" iron pin, set in a drill hole in bedrock, bears N.45°12'E., 19.87 ft., with attached 2" aluminum cap marked RP 1 2024 PLS 69454
- ▶ A 5/8"x 8" iron pin, set in a drill hole in bedrock, bears S.44°49'E., 22.42 ft., with attached 2" aluminum cap marked RP 2 2024 PLS 69454
- ▶ A 5/8"x 8" iron pin, set in a drill hole in bedrock, bears N.45°29'W., 11.54 ft., with attached 2" aluminum cap marked RP 3 2024 PLS 69454

CORNER MONUMENT MARKED:

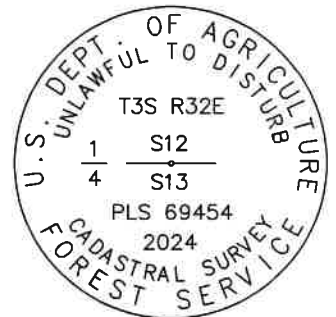

Deposited corner stone south and alongside the pipe, with the marked face down. Placed a blue plastic-encased magnet at base of pipe. Painted a 6 inch red band around the new bearing tree, and also painted blazes red and attached USFS 54-3 and 54-9 signs. Used RTK GPS to measure accessories. Distance to BT measured to a Mag Spike driven in the side-center-right at the root crown of the tree, with an attached 1½" aluminum washer stamped PLS 69454. Bearings are geodetic, derived by GPS observation at the corner.

RESTORATION BY, STAMP AND DATE:

Work completed June 26, 2024 by:

Jason L. Hatfield, PLS

USDA FOREST SERVICE
 NORTHEAST OREGON LAND ZONE
 1550 Dewey Avenue, Suite A
 Baker City, OR 97814
 (541) 523-1283

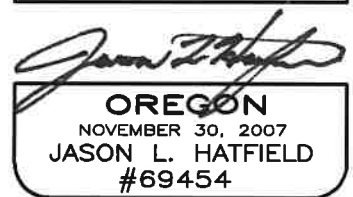

EXPIRES: 6/30/2025

24-078-8