

OREGON CORNER RESTORATION FORM

Section 11 Township 3S Range 32E  
 County Umatilla Date: October 22nd, 2022

Corner Designation: 3S32G21

Condition report only  
 Not Found

Quarter Corner common to Sections 11, and 12, T3S,  
 R32E, W.M., Umatilla County, Oregon.

X Remonumented  
X Unrecorded  
X Surveyed In  
X Referenced Out

Previous Renewals, Surveys, etc...

This corner was originally set by George S. Pershin under GLO contract 430 dated March 23rd, 1882. His record reads: A Fir. 4 ins. diam. on N.W. slope for 1/4 Sec. Cor marked 1/4 on W. side, A Fir 5 ins. diam. brs. N. 46° E 19 lks. dist. Marked 1/4 S. B.T., A Fir 7 ins. diam. brs. N. 40 W. 18 lks. dist. Marked 1/4 S. B.T.

Monument and accessories found: (condition and source)  
 None. The point was reestablished by single proportion.

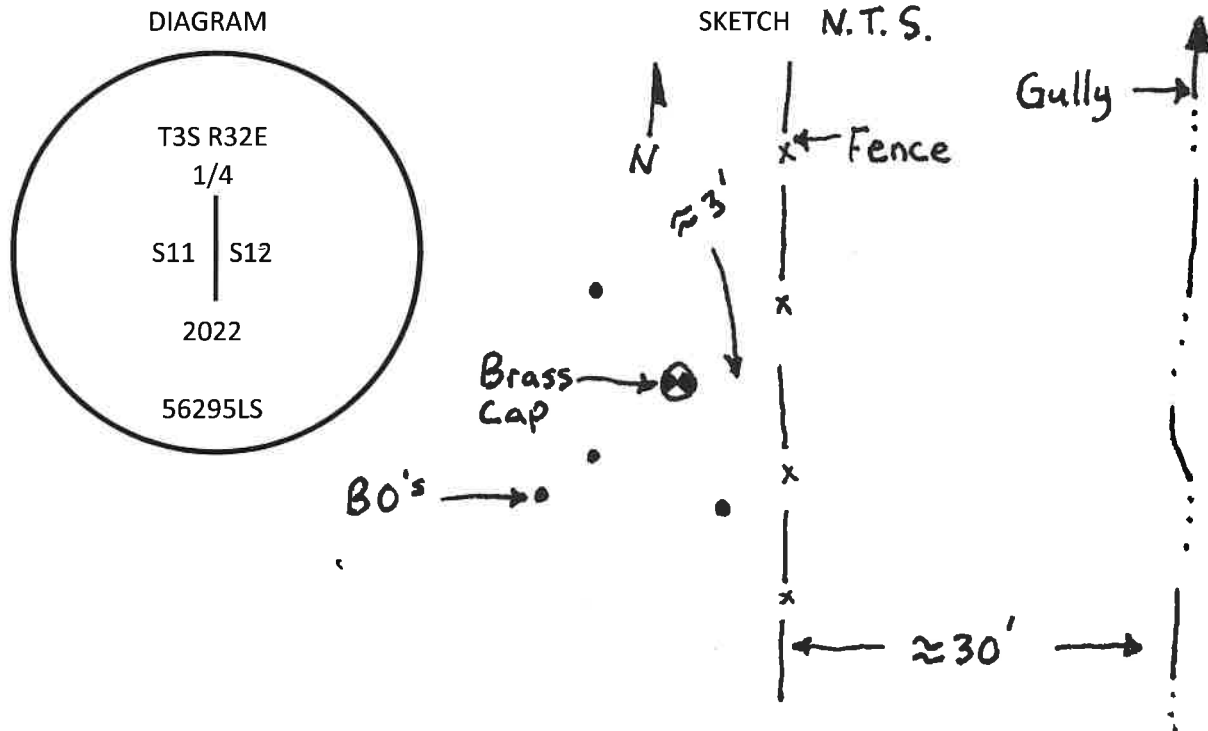

MONUMENT(S) AND ACCESSORIES SET (Procedures and Description)

At the proportionate point I set a 2 3/8" brass cap on a 1 1/2"x30" galvanized iron pipe 28 inches in the ground. The cap was stamped as shown in the diagram above.

For references I set four 5/8" by 24" iron rebars with 1.25" orange plastic caps stamped WTS and 56295LS as described below:

- An iron rebar bears N58°06'01"W, 53.24 feet flush with the surface;
- An iron rebar bears S63°57'39"W 39.81 feet flush with the surface;
- An iron rebar bears S64°04'42"W 60.92 feet flush with the surface;
- An iron rebar bears S07°41'59"W 42.18 feet flush with the surface;

The monument was set using a Trimble R8S RTK GPS Base - Rover pair.

Location and comments:

Compass Declination

Surveyor's Seal

RECEIVED BY: CT  
 Umatilla County Surveyor  
 Date: 11/21/22  
 Rec'd By:  
22-131-8

Firm / Agency  
 Witness Tree Surveying  
 Address  
 P.O. Box G  
 Pilot Rock, OR 97868  
 Party Chief  
 Stephen K. Haddock

REGISTERED  
 PROFESSIONAL  
 LAND SURVEYOR

*Stephen K. Haddock*

OREGON  
 JULY 9, 2001  
 STEPHEN K. HADDOCK  
 56295LS

RENEWS: 6-30-23