

RECORD OF LAND CORNER MONUMENTATION

NORTHWEST CORNER SECTION 12, T. 3 S., R. 32 E., W.M.

ORIGINALLY ESTABLISHED BY: George S. Pershin, U.S. Deputy Surveyor

CONTRACT NUMBER: 430

CONTRACT DATE: March 23, 1882

SUBSEQUENT SURVEYS:

- ▶ 1977 Remonumentation by Craig L. Wanless, BLM Cadastral Surveyor, under special instructions dated May 3, 1957, Group No. 350, approved May 6, 1957.
- ▶ 1984 Remonumentation by Fayette S. Munro, PLS #1832, recorded in the Umatilla County Surveyor's office October 10, 1984, as Survey No. 84-122-R

2	1	1	6
11	12	12	7
11	12	12	7
14	13	13	18

ORIGINAL DESCRIPTION: Set a basalt stone 15 x 8 x 7 ins 10 ins in ground on North Slope for cor. to Sec. 1, 2, 11 & 12 marked with 5 notches on S. and 1 notch on E edges from which
 A Pine 8 ins. di. brs. N.86°E. 78 lks dist marked T3S.R.32E S.1 B.T.
 A Tamarack 12 ins. di. brs. S38°E, 19 lks. dist marked T3S. R.32E. S.12 B.T.
 A Pine 6 ins. di. brs. S.56°W. 9 lks dist marked T3S. R.32E. S.11 B.T.
 A Tamarack 18 ins. di. brs. N38°W, 31 lks. dist marked T3S. R.32E. S.2 B.T.

1977 REMONUMENTATION: The cor. of secs. 1, 2, 11, and 12, monumented with the original unmarked basalt stone, 15 x 8 x 7 ins., firmly set 6 ins. in the ground, from which the remains of the original bearing trees:
 A pine, 14 ins. diam., bears N. 88° E., 78 lks. dist., with scribe marks T3S R32E S1 BT visible on open blaze. (Record, N. 86° E.); A pine, 11 ins. diam., bears S. 46° W., 9 lks. dist., with scribe marks E S visible on partially healed blaze. (Record, S. 56° W.); A decayed larch stump, size indeterminate, bears N. 21° W., 31 lks. dist., with a down larch alongside, 22 ins. diam., with scribe marks T3S R32E S2 BT visible on open double blaze. (Record, N. 38° W.)
 At the corner point Set an iron post, 28 ins. long, 2 1/2 ins. diam., 22 ins. in the ground, with brass cap mkd. (diagram shown) from which new bearing trees A grand fir, 13 ins. diam., bears S. 57 1/2° E., 38 lks. dist., mkd. T3S R32E S12 BT; A grand fir, 11 ins. diam., bears N. 52° W., 33 lks. dist., mkd. T3S R32E S2 BT.

1984 REMONUMENTATION: Munro found the BLM brass-capped monument and both bearing trees by the BLM from 1977. He also found the SW bearing tree by the GLO. He scribed a new bearing tree. His record states: A W. Fir, 13" dia., N46 1/2°E, 29.4 ft marked: T3S R32E S1 BT

EVIDENCE FOUND: Found 2 1/2" galvanized iron pipe with 3 1/4" BLM brass cap (marked as shown below), projecting 12" above ground. From which, a lodgepole pine 18" dbh, bears S.47°W., 6.3 ft., with partially healed blaze (GLO bearing tree). SE bearing tree now a broken-off snag. All other bearing trees of record are dead and down.

DESCRIPTION OF MONUMENTS AND ACCESSORIES SET AND METHODS USED:

I accept the found monument for the true corner.

From which, **I SCRIBE NEW BEARING TREES:**

- ▶ A Douglas-fir, 10" dbh, bears N.54°E., 20.5 ft., marked *T3SR32ES1* in upper blaze, and *BT* in lower blaze.
- ▶ A western larch, 4" dbh, bears S.83°E., 27.49 ft., marked *X* in upper blaze, and *BT* in lower blaze.
- ▶ A ponderosa pine, 8" dbh, bears N.65°W., 37.67 ft., marked *T3SR32ES2* in upper blaze, and *BT* in lower blaze.

CORNER MONUMENT MARKED:

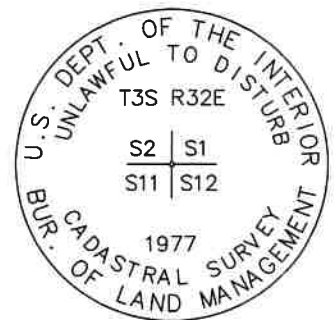

Painted a 6 inch red band around each bearing tree, and also painted blazes red and attached USFS 54-3 and 54-9 signs. Distances to new bearing trees measured with a steel tape to a Mag Spike driven in the side-center-right at the root crown of each tree, with an attached 1 1/2" aluminum washer stamped *PLS 69454*. Used RTK GPS to measure bearings. Bearings are geodetic, derived from GPS observation at the corner. Set an aluminum guard post south, with USFS 54-2 sign attached.

RESTORATION BY, STAMP AND DATE:

Work completed June 12, 2024 by:

Jason L. Hatfield, PLS
 Vince L. Kelly, Survey Technician
 Spencer B. Jones, Survey Technician

USDA FOREST SERVICE
 NORTHEAST OREGON LAND ZONE
 1550 Dewey Avenue, Suite A
 Baker City, OR 97814
 (541) 523-1283



EXPIRES: 6/30/2025

24-078-B