

Index  
File No. R-13

CORNER RECORD (SEARCH)

Tract or  
Survey No. 5-66 Cor.  
No. R-13

T 3S R. 31E R.D. Ukiah County Umatilla  
Merid. Willamette N.F. Umatilla State Oregon

CORNER DIAGRAM

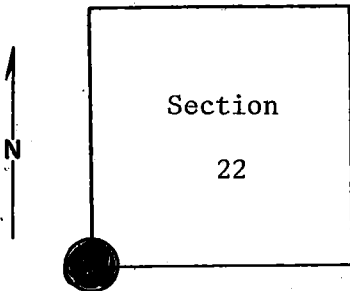

DESCRIBE CORNER MONUMENT FOUND

Material: Granite stone. Size: 20" x 14" x 5".

10 inches above ground; good condition. No markings visible.

*Monumented By BLM 1978*

DESCRIBE BEARING TREES OR OTHER OFFICIAL ACCESSORIES FOUND

20-inch p.pine stump 4 feet high with scribing on SW face--  
R31E, S22, B.T. (bears N31°E, 15 foot distance). *from stone,*

Stump hole bears S20°W, approximately 24 feet. Bearing tree  
is 12" ~~stump~~ fir laying on ground 20 feet NW of stump hole, with  
scribing face up. Scribing: T3S, R31E, S28, B.T.  
(cont. in block 12.)

DESCRIBE CORNER LOCATION RELATIVE TO NEAR-BY FEATURES, ALSO HOW TO REACH CORNER

PHOTO IDENTIFICATION DATA

Photo No. \_\_\_\_\_  
Filed At. \_\_\_\_\_  
Object Ident. \_\_\_\_\_  
Ident. By \_\_\_\_\_

*Signature*

PLANE COORDINATE POSITION DATA

State \_\_\_\_\_ Zone \_\_\_\_\_  
X \_\_\_\_\_  
Y \_\_\_\_\_  
Estab. By \_\_\_\_\_  
*Agency*

Signature:  
B, Moore

Title  
Engineering Technician

Division  
Headquarters  
S,O,

Date  
November 1974

7100-52  
REV. 65 5

CORNER RECORD (PERPETUATION)

MONUMENT : DESCRIBE NEW MONUMENT SET, OR WORK DONE TO PRESERVE EXISTING MONUMENT

9

ACCESSORIES : DESCRIBE NEW BT'S WITNESS OBJECTS ETC. ESTABLISHED, OR WORK DONE TO PRESERVE EXISTING EVIDENCE

10

Work Done By \_\_\_\_\_ Title \_\_\_\_\_ Date \_\_\_\_\_ State Registration No. \_\_\_\_\_  
or Agency \_\_\_\_\_

Certified Cor. Record Prepared ? Yes No Filed At \_\_\_\_\_ Date \_\_\_\_\_ 11

REMARKS

12-inch fir stump, 1 foot high, bears S30°E, approximately 30 feet from stone corner  
(possible B.T.).  
Old logging operations have probably destroyed other B.T. in NW quadrant.  
B.T.'s identified with B.T. tags:

12

Index File No. T. R. M. Tract or Surv. No. Cor. 13