

History of original corner establishment:

The original corner was established by George S. Pershin on November 6, 1878, under contract number 304, as follows:

Set a stone, 24" x 14" x 12", on north hillside. Dug pits and drove a stake and raised a stone mound around the corner.

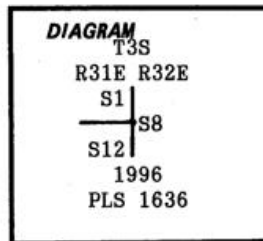

Description of corner evidence found:

A basalt stone, 20" x 12" x 10", marked with one groove on the north face and one notch on the south edge, is solidly set with a mound of stones west of and alongside the corner stone. The stake is gone.

**REGISTERED
PROFESSIONAL
LAND SURVEYOR**

Dennis L. Gaylord

OREGON
JULY 14 1978
DENNIS L. GAYLORD
1636

Renews 6/30/97

Description of monument and accessories established to perpetuate the original location of this corner:

In place of the stone, I set a 1" x 30" iron pipe, 18" into the ground. A 2 1/2" brass cap attached is marked as shown in the diagram above. I bury the corner stone alongside the south side of the iron pipe and build a mound of stones around the pipe to the cap. From which:

A 3/4" x 24" aluminum rod is set 22" into the ground and has a 5/8" brass washer, marked "PLS 1636", wired to the rod at ground level. The rod bears N68°30'E, 21.7 feet.

A 3/4" x 24" aluminum rod is set 22" into the ground and has a blue unmarked plastic cap and a 5/8" brass washer, marked "PLS 1636", wired to the rod at ground level. The rod bears S46°E, 50.5 feet.

A 5/8" x 36" iron rod is set 28" into the ground. A 1 1/2" aluminum cap attached is marked "42.0 LS 1636" and an arrow pointing toward the corner. The rod bears S51°30'W, 42.0 feet.

A 5/8" x 24" iron rod is set 22" into the ground. A 1 1/2" aluminum cap attached is marked "33.4 LS 1636" and an arrow pointing toward the corner. The rod bears N51°30'W, 33.4 feet.

I hereby certify the above corner point was perpetuated as hereon described on June 9, 1996. Magnetic declination: 20°E.

Office of County Surveyor County of UMATILLA
 State of OREGON, I hereby certify that the within instrument was filed in this office
 for record on the 24 day of June, 1996
David H. Kline by _____
 (COUNTY OFFICIAL) (DEPUTY)

E-25

RECEIVED BY

Umatilla County Surveyor
 Date 6-96
 Rec'd By KK
 No. 96-110-R

CERTIFIED RECORD OF LAND CORNER MONUMENTATION

E - 25
DIAGRAM

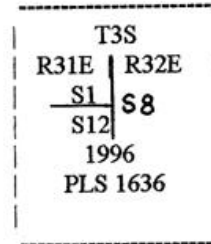

History of original corner establishment:

The original corner was established by George S. Pershin on November 6, 1878, under GLO contract No. 304, as follows:

Set stone, 20" x 12" x 10", on northeast face of mountain for corner to sections 1, 12, 6 and 7. Dug pits and drove stake and raised a mound of stones around the corner.

This corner was made a section corner of minimum control for sections 1 and 12, only, by the subsequent subdivision survey of township 3 south, range 32 east by George S. Pershin under GLO contract Number 430, dated March 23, 1882.

Description of corner evidence recovered:

Found the original corner stone set at the east side of a mound of stones. The corner stone is basalt, 20" x 12" x 10", and is marked with one groove on the north face and one notch on the south edge. The original post and pits are gone.

Monument and accessories established to perpetuate the original position of this corner:

At the exact point occupied by the original corner stone, I set a 1" x 30" flared galvanized iron pipe 18" into the ground. I bury the original corner stone along the south side of the pipe and build a mound of stones around the pipe. A 2 1/2" brass cap attached to the pipe is marked as shown in the diagram above, from which:

A 5/8" x 24" iron rod set 22" into the ground with a 1 1/2" aluminum cap attached, marked "33.4 LS 1636" and an arrow pointing toward the corner, bears N51° 30'W, 33.4 feet.

A 3/4" x 24" aluminum rod set 22" into the ground with a 5/8" brass washer, marked "PLS 1636", attached at ground level, bears N68° 30'E, 21.7 feet.

A 3/4" x 24" aluminum rod set 22" into the ground with an unmarked blue plastic cap attached to the top of the rod, and a 5/8" brass washer, marked "PLS 1636", attached at ground level, bears S46°E, 50.5 feet.

A 5/8" x 36" iron rod set 28" into the ground with a 1 1/2" aluminum cap attached, marked "LS 1636 42.0" and an arrow pointing toward the corner, bears S1° 30'W, 42.0 feet. I build a small mound of stones around this iron rod.

I hereby certify the above corner point was perpetuated as hereon described on June 9, 1996. Magnetic declination set in compass: 20°E. This document is prepared on February 26, 2001, at the request of the Umatilla County Surveyor, as the Corner Certification Form for this corner recorded with the County Surveyor in June of 1996 has been misplaced.

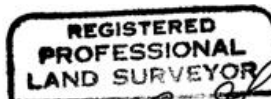

Dennis L. Gaylord

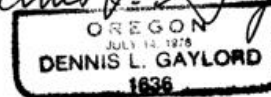

Renews June 30, 2001

Re-recorded at the office of County Surveyor, County of Umatilla, State of Oregon, on

96-110-R