

Index
File No. WB 922
T 3N R. 37E
Merid. WILLAMETTE

CORNER RECORD (SEARCH)

(Ref. FSM 7151.4)

R.D. WALLA WALLA County UMATILLA
N.F. UMATILLA State OREGON
Tract or Survey No. _____
Cor. No. _____

CORNER DIAGRAM

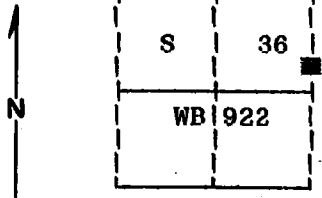

DESCRIBE CORNER MONUMENT FOUND

Corner not previously established.

DESCRIBE BEARING TREES OR OTHER OFFICIAL ACCESSORIES FOUND

No accessories previously established.

PHOTO IDENTIFICATION DATA

Photo No. _____
Filed At. _____
Object Ident. _____
Ident. By _____
Signature

DESCRIBE CORNER LOCATION RELATIVE TO NEAR-BY FEATURES, ALSO HOW TO REACH CORNER

Corner falls in a clearcut approximately 100 feet North of the 3150-035 road.

PLANE COORDINATE POSITION DATA

State _____ Zone _____
X _____
Y _____
Estab. By _____

Signature
Agency

Title _____ Division _____ Headquarters _____ Date _____

CORNER RECORD (PERPETUATION)

MONUMENT: DESCRIBE NEW MONUMENT SET, OR WORK DONE TO PRESERVE EXISTING MONUMENT

Set a 2½"x30" aluminum pipe with aluminum cap marked as shown:
Pipe is set 30 inches in the ground.

WB 922

1991
OPLS 644

9

ACCESSORIES : DESCRIBE NEW BT'S WITNESS OBJECTS ETC. ESTABLISHED, OR WORK DONE TO PRESERVE EXISTING EVIDENCE

New BOs:

A 5/8"x30" iron pin with plastic cap marked BGA SURVEY MARKER bears N66°W, 22.64 feet
A ½"x30" iron pin with plastic cap marked BGA MARKER bears S87°W, 22.22 feet

Set a steel fencepost approximately 5 feet West with
Land Survey Monument and Wilderness Boundary signs attached.

10

Work Done By D.I. Griffith Title Surveyor Date 10-10-92 State Registration No. OPLS 644
or Agency

Certified Cor. Record Prepared ? Yes No Filed At: Umatilla Co. Surveyor Off. Date 10-92

11

REMARKS

Witnesses: Jeff Petersen and Jim Bennett

12

Index File No. T. R. M. Tract or Surv. No. Cor.

13