

CERTIFIED RECORD OF LAND CORNER MONUMENTATION

R-17  
T3N R36E

CORNER TO SECTIONS 22, 23, 26, + 27, T3N R36E

History of original corner establishment:

ESTABLISHED BY G. S. PERSHIN UNDER HIS CONTRACT  
No. 305, DATED SEPT. 20, 1878. HIS NOTES READ AS  
FOLLOWS: SET PINE POST ON WEST HILLSIDE FOR COR. TO  
SEC. 22, 23, 26 AND 27.

- A FIR, 8 IN. DIAM. BRG. N.60°E. 23 LKS. DIST.
- A FIR 10 IN DIAM. BRG. S.60°E. 17 LKS. DIST.
- A FIR 8 IN DIAM. BRG. S.41°W. 14 LKS. DIST.
- A FIR 8 IN DIAM BRG N10°W. 8 LKS. DIST.

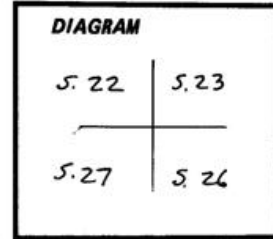

Description of corner evidence found:

FOUND 1 1/2" GALV. IRON PIPE WITH 2 1/2" BRASS CAP, MKD. AS SHOWN  
FROM WHICH:

- 22" FIR, SCRIBES "T3N R36E S23BT" ON OPEN FACE, BEARS  
N 29°E, 18.75 FT.
- 16" FIR, PITCHED OVER FACE, BEARS N 18°W, 19.25 FT.
- 8" FIR, PITCHED OVER FACE, BEARS S 57°W, 25.4 FT.
- 6" FIR, PITCHED OVER FACE, BEARS S 51°E, 19.15 FT.

UMATILLA COUNTY  
T3N R36E  
S22 | S23  
S27 | S26  
1983  
PLS 933  
SURVEYOR

Description of monument and accessories | established to perpetuate the original location of this corner:

NONE. ALL BT'S ARE IN GOOD CONDITION.

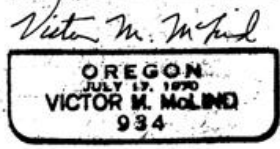
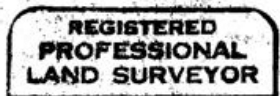

RECEIVED BY  
Umatilla County Surveyor  
Date 7-8-86  
Rec'd By KA  
No. 86-84-M  
(86-37-B)

Office of..... County of.....  
State of....., I hereby certify that the within instrument was filed in this office  
for record on the..... day of....., 19.....  
..... by .....

(COUNTY OFFICIAL)

(DEPUTY)