

# OREGON CORNER RESTORATION FORM

Section 30 Township 3N Range 35E  
 County Umatilla Date: 09-02-2004

Corner Designation: 3N35EV1

<input checked="" type="checkbox"/> x <input type="checkbox"/> <input type="checkbox"/> <input type="checkbox"/> <input type="checkbox"/>	Condition Report Only Not Found Remonumented Unrecorded Surveyed In Referenced Out
---	---

Previous Renewals / Surveys, etc.  
 Corner brass cap set by Redfield in 1919.

**Monument and Accessories Found: ( condition and source )**

Found 3.25" dia. brass cap un-stamped as shown in the diagram below, and in the attached photographs. The brass cap was located at the intersection of Duff Road (County Road # 794) and Pambrun Road (County Road # 737). The cap was 4 inches below the road surface, and is without any section stampings (see attached photographs).

DIAGRAM



SKETCH

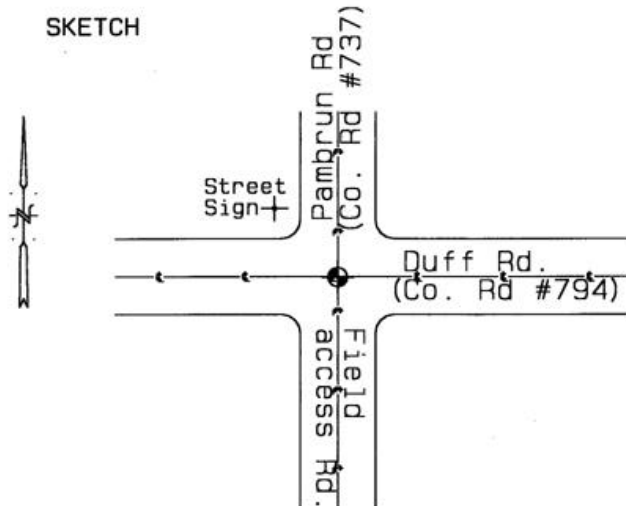

**REFERENCES:**

Single point GPS tie.  
 Latitude 45°42'08.8"N  
 Longitude 118°29'52.3"W  
 NAD 83 (1991)

Oregon State Plane Coord. - North Zone  
 Northing 748540'  
 Easting 8713570'  
 Ellipsoidal Height 1946'

RECEIVED BY:

Date: \_\_\_\_\_  
 Rec'd By: \_\_\_\_\_  
 No. 05-009-R

Firm / Agency

Haddock Surveying  
 P. O. Box 1574  
 Pendleton, OR 97801  
 (541) 276-2174

REGISTERED  
 PROFESSIONAL  
 LAND SURVEYOR

*David L. Haddock*

OREGON  
 JULY 12, 1968  
 DAVID L. HADDOCK  
 852