

OREGON CORNER RESTORATION FORM

COUNTY: Umatilla DATE: 12/22/15

CORNER DESIGNATION: L-25, The East Quarter Corner of Section 13, Township 3 North, Range 34 East, W.M.

PREVIOUS RENEWALS/SURVEYS ETC.: Corner originally established by Zenas F. Moody, under contract dated October 4, 1871. Notes State: Set a post and made mound of earth for quarter section corner. Currin and Noland under special contract dated May 4, 1887, state set post for quarter section corner.

MONUMENT AND ACCESSORIES FOUND: None. Held the intersection of the centerline of Pambrun Road North-South with a field berm extending West as the best remaining evidence of the corner.

MONUMENT MARKING DETAIL:

T3N
R34|R35
1/4
S13|S18
2015
PLS 54657

MONUMENT SET: At the corner point set a 2" aluminum cap on 5/8"x30" rebar with the top of the cap 2" below paved road surface. Monument marked as shown in "Monument Marking Detail".

From which:

- A 5/8"x24" iron rebar with 1 1/4" blue plastic cap marked "Wells Surveying PLS 54657" at ground level in in road bank bears GRID AZIMUTH 21°24', 44.4 feet.
- A 5/8"x24" iron rebar with 1 1/4" blue plastic cap marked "Wells Surveying PLS 54657" at ground level in road bank bears GRID AZIMUTH 153°21', 40.6 feet.
- A 5/8"x24" iron rebar with 1 1/4" blue plastic cap marked "Wells Surveying PLS 54657" at ground level in road bank bears GRID AZIMUTH 198°28', 39.1 feet.
- A 5/8"x24" iron rebar with 1 1/4" blue plastic cap marked "Wells Surveying PLS 54657" at ground level in unfarmed field triangle bears GRID AZIMUTH 276°31', 24.7 feet.

Wired bearing object signs to all rebar.

LOCATION AND COMMENTS: Corner is located at the intersection of the visual centerline of Pambrun Road and a field berm West. See Survey Map filed concurrently with this certificate for further information.

FIRM: Wells Surveying
P.O. Box 1696
Pendleton, OR 97801

COMPASS DECLINATION: 18° East Surveyor's Seal

/3N34L25

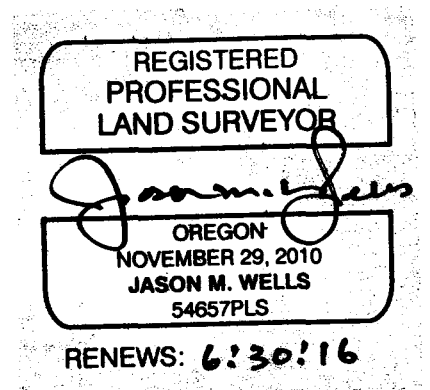

15-125-13