

OREGON CORNER REORIENTATION FORM

COUNTY: Umatilla DATE: 06/10/97

CORNER DESIGNATION: Z-17, The Southwest corner of Section 35, T4N., R35E., W.M.

PREVIOUS RENEWALS/SURVEYS, ETC.: Corner established by Wm. H. Odell, GLO Contract No. 114, dated July 2, 1866. Notes state: Set post corner for Sec. 2, 3, 34 & 35, drove charred stake, dug pits and raised mound as per instructions.

MONUMENT AND ACCESSORIES FOUND: None. Re-established corner position at fence intersection with fences extending East and West and ancient fence and field line extending North.

MONUMENT MARKING DETAIL:

T4N R35E  
S34 | S35  
S3 | S2  
T3N R35E  
1997  
PLS 1106

MONUMENT SET:

Set a 2 1/2" brass cap on a 1" x 30" galvanized iron pipe approximately 8 inches above ground in mound of rock, cap marked as shown in Monument Marking Detail.

Accessories:

A 5/8" x 24" iron rod with a yellow plastic cap marked "OR PLS 1106, WA PLS 17372" bears N 39° E, 19.5 feet.

A 5/8" x 24" iron rod with a yellow plastic cap marked "OR PLS 1106, WA PLS 17372" bears S 81° E, 9.1 feet.

A 5/8" x 24" iron rod with a yellow plastic cap marked "OR PLS 1106, WA PLS 17372" bears N 82° W, 18.4 feet.

A 5/8" x 24" iron rod with a yellow plastic cap marked "OR PLS 1106, WA PLS 17372" bears N 57° W, 23.2 feet.

Bearing object tags attached to iron rods, steel fence posts set nearby with witness signs attached.

Steel fence post set 1 foot Southwest of monument in fenceline with witness sign attached.

LOCATION & COMMENTS: Corner located in mound of rock in East-West fenceline.

COMPASS DECLINATION: 18° East

Surveyor's Seal

Witnesses: Kelly Snively  
Jason Wells

OREGON STATE PLANE NORTH CO-ORDINATE FOR CORNER, NAD 83(91), INT. FEET:

N: 775761.64  
E: 8734023.78

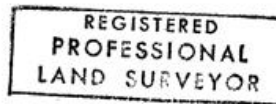

*William R. Wells*

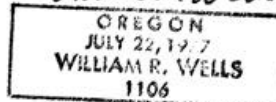

*Renews 6-30-98*