

CERTIFIED RECORD OF LAND CORNER MONUMENTATION

History of original corner establishment:

Index: A-17

Corner Sections 2 and 3, T3N, R34E, W.M.
and sections 34 and 35, T4N, R34E, W.M.

Original corner was set by James P. Currin and James E. Noland under special contract dated May 4th, 1887. their record reads:

Set a basalt stone 10x8x7 ins. 6 ins. in ground for corner to secs. 2,3,34, and 35. Marked 2 notches on the East and 4 notches on the West edges. Dug pits 18x18x12 ins. in each section 5 1/2 feet dist. and raised a mound of earth 2' high with a 4 1/2 foot base alongside.

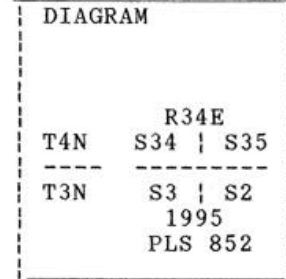

Description of corner evidence found:
None.

Description of monument and accessories I established to perpetuate the original location of this corner:

A position for this corner was established for this corner by PLS 933 in survey No. I-137-B, however no monument was set. I set a 2 1/2" brass cap on a 1 1/2x30" galvanized iron pipe stamped as in the diagram above, 0.7' below the surface of the road. This point was the intersection of the of the line described in the survey mentioned above with the centerline of county road No. 692. This position agrees with the county road notes. The position also agrees with the intersection of a North-South farm road with the county road and falls 0.4' east of a North-South irrigation main line which is 9" in diameter and 1.3' below the surface of the ground.
From the corner:

- A Power pole with a 1 1/4" brass washer stamped ORLS 852 and WALs 13922 bears N74°34'W, 75.3'.
- A Power pole with a 1 1/4" brass washer stamped ORLS 852 and WALs 13922 bears N87°03'E, 278.6'.
- A 5/8"x24" Iron Rebar with a 2" aluminum cap stamped ORLS 852 and WALs 13922 bears S43°10'W, 25.8, at the top of the cut slope.
- A 5/8"x24" Iron Rebar with a 2" aluminum cap stamped ORLS 852 and WALs 13922 bears S45°22'E, 26.9, in the center of the farm road.
- A 2 1/2" O.D. galvanized iron pipe with a 1 1/4" brass washer stamped ORLS 852 and WALs 13922 bears S1°29'W, 20.3', next to an irrigation valve box.

This work was done November 21, 1995.

Office of _____ County of _____
State of _____, I hereby certify that the within instrument was filed
in this office for record on the _____ day of _____, 19____.
_____ by _____
(COUNTY OFFICIAL) (DEPUTY)

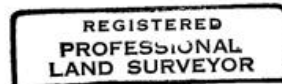

David L. Haddock

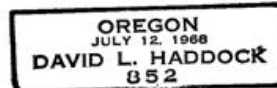

03-89-R