

OREGON CORNER RESTORATION FORM

Section 31 Township 3N Range 33E
 County Umatilla Date: May 5, 2001

Corner Designation: 3N33X1

Condition Report Only
 Not found
 Remonumented
 Unrecorded
 Surveyed in
 Referenced out

The 1/4 corner to section 36 R32E and section 31, R33E, W.M., Umatilla County, Oregon.

Previous Renewals / Surveys, etc.

Corner originally set by David P. Thompson under contract #106 dated August 16, 1864.

His record reads: Set post for corner to secs. 30, 31, 25, & 36 in mound of earth with charred stak pits, trench & c. as per instructions.

John Kimbrell set a stone 18x8x7 inches at the proportioned point in the survey recorded in Book 1 at page 526 of the record of private surveys on March 15, 1904.

Monument and Accessories found: (condition and source)

Kimbrell's stone was lying loose on the ground near a wooden post which was 17 feet west of the Township line.

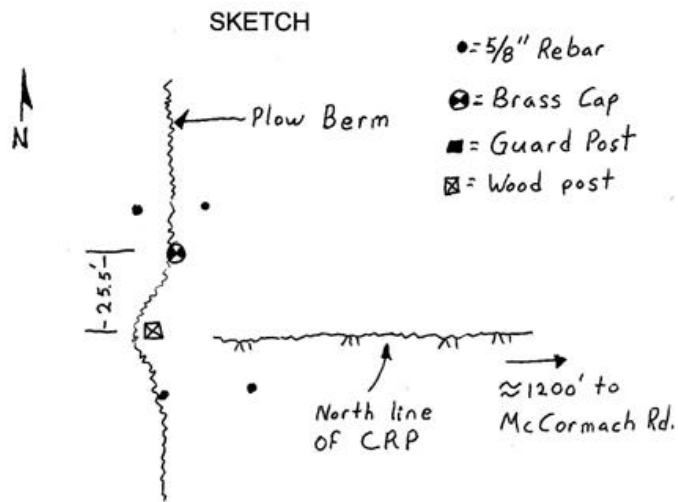
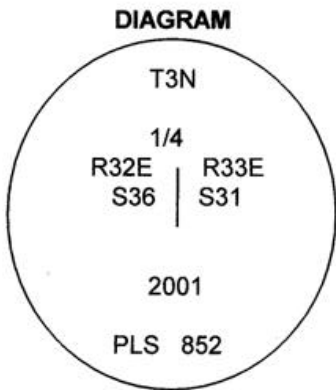

MONUMENT (S) AND ACCESSORIES SET (Procedures and Description)

Set a 1 1/2" x 30" galvanized iron pipe with a 2 1/4" brass cap stamped as shown in the diagram above at the proportioned point. Set a 6 foot steel fence post with a county monument sign sign attached along side.

For references, I set four, 5/8" by 24" rebars with 1.25" red plastic caps stamped ORLS 852 and WAL5 13922 as described below:

- an iron rebar bears N42°36'28"W, 22.62 feet 2 feet below the surface in a plowed field;
- an iron rebar bears N42°05'43"E, 24.05 feet 2 feet below the surface in a plowed field;
- an iron rebar bears S14°28'04"W, 48.96 feet 2 feet below the surface in a plowed field;
- an iron rebar bears S17°46'02"E, 49.99 feet 2 feet below the surface in a CRP field;

The monument and references were tied using a LIECA system 300 RTK GPS.

Location and comments

Compass Declination

Surveyors Seal

RECEIVED BY:
 Umatilla County Surveyor
 Date: 6-01
 Rec'd By: XF
 No. 01-81-C

Firm / Agency
 Haddock Surveying
 Address
 P.O. Box 1574
 Pendleton, Or. 97801
 Party Chief
 Stephen K, Haddock

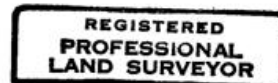

David L. Haddock

