

OREGON CORNER RESTORATION FORM

COUNTY: Umatilla

DATE: 08-27-2012

CORNER DESIGNATION:

T-5, The West Quarter Corner of Section 29, Township 3 North, Range 32 East, Willamette Meridian, Umatilla County, Oregon.

PREVIOUS RENEWALS / SURVEYS, ETC.:

The corner was originally established by U.S. Deputy Surveyor, Daniel Chaplin, under contract No. 107 in 1864, who set a post for Sections 29 & 30 in a mound of Earth with charred stake, pits &c.

The survey for the establishment of Hagen Road (Road 179) in 1884 states "run North on line between Sections 29 & 30". No monument is mentioned or shown in the field survey notes for the corner in question.

The survey for the establishment of Snyder Road (Road 306) in 1887 states "Set initial post 45 links East & 15 links North of Center of Section 27 and run thence on subdivision 1/2 Section lines west"... " 200.00 chains set terminus post on line on West side of road in lane course North & South at 1/4 corner between Sections 29 & 30".

An undated, hand prepared sketch found in the records of the Umatilla County Surveyors Office shows the hand written note "(charred stake) stone and glass". It appears that this sketch is from the old Hayes and Harris files.

MONUMENT AND ACCESSORIES FOUND:

Accepted the intersection of the apparent center line of Hagen Road and the apparent center line of Snyder Road as the best remaining evidence of the original corner position. See the 2012 J-U-B Engineers, Inc. Partition Plat for Tim Weidert for complete survey and corner details.

MONUMENT MARKING DETAIL:

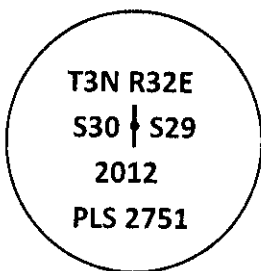

MONUMENT SET:

Set 2-1/4" x 12" Aluminum pipe with a 3-1/4" Aluminum Cap with Deep-1 magnet in concrete, buried 6" below gravel road surface. The monument is approximately 0.5" East of the apparent center line of Hagen Road (12' gravel surface) and 1.2' North of the apparent center line of Snyder Road (12' gravel). The Aluminum Cap is marked as shown above in the Monument Marking Detail.

RECEIVED BY

Umatilla County Surveyor

Date: 9/10/12

Rec'd By: S. Des

No.: 12-121-R

NEW ACCESSORIES:

Set mag nail with red plastic washer stamped "JUB Control" in 5-0' tall railroad tie fence post near telephone riser in the Southeast quadrant of Snyder Road and Hagen Road intersection, 1.0' above ground in West side of said fence post with bearing tag which bears S63°E, 48.00' from Aluminum Cap.

Set a 1/2" x 24" iron rebar with red plastic cap stamped "JUB Control" in the West shoulder of Hagen Road, 6" below road surface which bears N29°W, 22.23' from Aluminum Cap.

LOCATION AND COMMENTS:

The corner is located in the Southeast quadrant of the intersection of Hagen Road and Snyder Road.

REFERENCE OBJECT MEASUREMENT PROCEDURE:

Reference bearings were obtained with a Silva Ranger Compass with a declination of 15° East. Reference distances were measured using a 100-foot steel tape.

FIRM / AGENCY:

J-U-B Engineers, Inc.
2810 W. Clearwater Avenue, Suite 201
Kennewick, WA 99336
509-783-2144

WITNESSES:

Steven Day, Party Chief
Felipe Hernandez, Instrument Man

SURVEYOR'S SEAL

08-27-2012

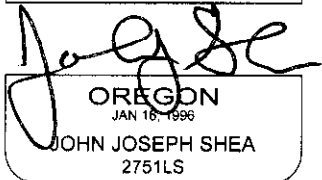
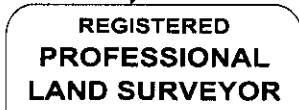

RENEWAL DATE: 6-30-14

RECEIVED BY

Umatilla County Surveyor
Date: 9/10/12
Rec'd By: S. Ous
No.: 12-121-R