

OREGON CORNER RESTORATION FORM

COUNTY: Umatilla DATE: 04/05/04

CORNER DESIGNATION: N-9, The Southwest Corner of Section 16, Township 3 North, Range 32 East, W.M., Umatilla County, Oregon.

PREVIOUS RENEWALS/SURVEYS ETC.: Corner was originally established by David P. Thompson, under GLO contract No. 106, dated August 16, 1864. Record states: Set post for corner to Secs. 16, 17, 20 & 21 in mound of Earth with charred stake, pits &c as per instructions. An undated, hand written sketch found in County Survey office files, notes "stone" at corner point. I suspect this sketch is from old Hayes and Harris files.

MONUMENT AND ACCESSORIES FOUND: Lone wood post with field lines extending North-South-East and West. County Road No. 353, now vacated, formerly passed East-West through the corner point.

MONUMENT MARKING DETAIL:

T3N R32E
S17 | S16
S20 | S21
2004
PLS 1106

MONUMENT SET: Accepted intersection of field lines extending North-South-East and West as best remaining evidence of original corner location. Set a 2 1/2" brass cap on a 1 1/4" x 30" galvanized iron pipe with cap buried 14" below ground level. The monument is 0.5' East of East edge of existing wood post. Monument is marked as shown in "Monument Marking Detail".

New Accessories:

- A silver deep-1 magnet buried 20" below ground level bears N 37° E, 28.2 feet.
- A purple deep-1 magnet buried 20" below ground level bears S 31° E, 34.2 feet.
- A blue deep-1 magnet buried 20" below ground level bears S 33° W, 28.2 feet.
- An orange deep-1 magnet buried 20" below ground level bears N 46° W, 37.5 feet.
- Buried bearing object tags with deep-1 magnets, Nailed "witness" sign to wood fence post beside new monument.

LOCATION AND COMMENTS: Corner is in active wheat fields, at a lone wood post with field lines North, South, East, and West.

FIRM: William R. Wells, PLS
P.O. Box 1696
Pendleton, OR 97801

COMPASS DECLINATION: 18° East

Surveyor's Seal

Witnesses: Jason Wells, LSIT
Marc Hammersla
13N32N9

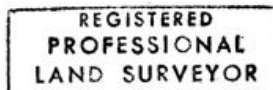

Will. R. Wells

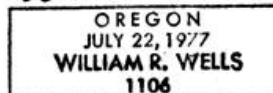

renews 6-30-04