

OREGON CORNER RESTORATION FORM

COUNTY: Umatilla DATE: 3/31/15

CORNER DESIGNATION: The Northwest Corner of Section 11, Township 3 North, Range 31 East, E-17.

PREVIOUS RENEWALS/SURVEYS ETC.: Corner originally established by D.S. Payne, under Contract No. 100, dated 8/1/1861, notes state: Set charred stake with mound trench and pits as per instructions for corner to secs 2, 3, 10 & 11. Corner re-established by Dave Krumbein, at a road an fence line intersection, in Survey M-108-B, dated 1976. Corner was monumented with a brass cap monument.

MONUMENT AND ACCESSORIES FOUND: None. The Krumbein monument is missing.

MONUMENT MARKING DETAIL:

T3N R31E
S3|S2
S10|S11
2015
PLS 54657

MONUMENT SET:

Re-established corner position by turning record angle of 89°13'10" right from SW corner of Section 3, backsighting the West one-quarter corner of Section 3, and measuring grid distance from SW corner of Section 3. At re-established corner point, set a 2 3/8" brass cap on a 1 1/4" x 30" galvanized iron pipe, with top 16" below ground, stamped as shown in "Monument Marking Detail".

From which:

- A silver deep-1 magnet buried 20" in the ground, bears North 39° East, 35.7 feet.
 - A pink deep-1 magnet buried 20" in the ground, bears South 45° East, 35.7 feet.
 - A blue deep-1 magnet buried 20" in the ground, bears South 37° West, 35.0 feet.
 - An orange deep-1 magnet buried 20" in the ground, bears North 51° West, 33.2 feet.
- Buried bearing object tags with magnets.

LOCATION AND COMMENTS: No distinct features remain. Corner falls in CRP field.

OREGON STATE PLANE COORDINATE, North Zone, NAD 83(91), International Feet:

N = 768013.62
E = 8607311.85

FIRM: Wells Surveying
P.O. Box 1696
Pendleton, OR 97801

COMPASS DECLINATION: 18° East Surveyor's Seal

Witnesses: Jason Wells, PLS
Dean Roy

/3N31E17

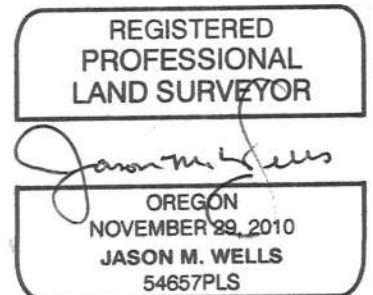

RENEWS: 6-30-16

15-052-c