

OREGON CORNER RESTORATION FORM

COUNTY: Umatilla DATE: 03/8/06

CORNER DESIGNATION: 3N31, T-1, The West One-Quarter Corner of Section 30.

PREVIOUS RENEWALS/SURVEYS ETC.: Corner established by David P. Thompson under Contract No. 81, dated July 8, 1859. Record states: Set post for 1/4 Sec. corner and build mound of earth with pits, trench &c., as per instructions. State Highway Department freeway right-of-way and monumentation maps for Interstate 84 show a State Plane coordinate (NAD 27) for this corner. The maps do not indicate what was recovered.

MONUMENT AND ACCESSORIES FOUND: None.

MONUMENT MARKING DETAIL:

T3N
R30E R31E
1
4
S25 | S30
2006
PLS 1106

MONUMENT SET:

Re-established corner using indexed Oregon State Highway Department freeway map coordinates, after indexing State coordinates to our State Plane measurement values at freeway centerline monuments at 930+94.45 and 985+59.60. At reestablished corner position, set a 2" brass disk in concrete flush with asphalt pavement. Disk marked as shown in monument marking detail.

From which:

A 3/4" brass washer stamped "PLS 1106" 1 foot above ground level in a wood guard rail post bears North 46° East, 34.3 feet.

A 3/4" brass washer stamped "PLS 1106" 1 foot above ground level in a wood guard rail post bears South 45° East, 34.1 feet.

A 3/4" brass washer stamped "PLS 1106" 1 foot above ground level in a wood guard rail post bears South 33° West, 31.7 feet.

A 3/4" brass washer stamped "PLS 1106" 1 foot above ground level in a wood guard rail post bears North 22 1/2° West, 31.1 feet.

The most Southeasterly bolt with nut of metal bridge deck guard rail bears North 10° West, 64.9 feet.

The most Southwesterly bolt with nut of metal bridge deck guard rail bears North 24 1/2° East, 53.0 feet.

Attached bearing object signs to wood guard rail posts by brass washers.

LOCATION AND COMMENTS: Corner is located 50+- feet South of South end of concrete bridge crossing Interstate 84 on Yoakum Road.

OREGON STATE PLANE COORDINATE, North Zone, NAD 83(91), International Feet:

N = 749273.93
E = 8586294.88

FIRM: William R. Wells, PLS
P.O. Box 1696
Pendleton, OR 97801

COMPASS DECLINATION: 18° East

Witnesses: Jason Wells, LSIT

/3N31T1

Surveyor's Seal

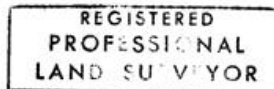

William R. Wells

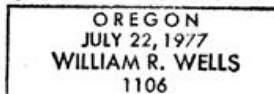

Revised to 2006 N-462-C