

**OREGON CORNER RESTORATION FORM**

COUNTY: Umatilla DATE: 02/01/06

CORNER DESIGNATION: 3N31, N-1, The Northwest Corner of Section 19.

PREVIOUS RENEWALS/SURVEYS ETC.: Corner established by David P. Thompson, under Contract No. 81, dated July 8, 1859. Record states: Set post for corner to Secs. 18, 19, 13 & 24 and build mound of earth with pits, trench &c., as per instructions.

Corner previously remonumented by Registered Land Surveyor No. 933, on Umatilla County Survey No. I-5-A, (also numbered 03-212-A).

**MONUMENT AND ACCESSORIES FOUND:**

Found 2 1/2" brass cap on 1 1/4" diameter galvanized iron pipe with top 6" above ground level. Cap stamped as shown in Monument Marking Detail.

**MONUMENT MARKING DETAIL:**

T3N  
R30E R31E  
S13|S18  
S24|S19  
RLS 933

**NEW ACCESSORIES:**

A 3/4" washer stamped "PLS 1106" nailed 1 foot above ground in UECA Power Pole No. 180001 bears, North 04 1/2° West, 20.4 feet.

A 5/8" x 24" iron rebar with yellow plastic cap stamped "OR PLS 1106, WA PLS 17372", bears North 04 1/2° West, 43.6 feet.

A 5/8" x 24" iron rebar with yellow plastic cap stamped "OR PLS 1106, WA PLS 17372", bears South 04° West, 36.8 feet.

A 5/8" x 24" iron rebar in fence line with yellow plastic cap stamped "OR PLS 1106, WA PLS 17372", bears North 89° West, 42.2 feet.

Attached bearing object signs to all rebar accessories. Nailed witness post sign to railroad tie fence corner 2 feet South of monument.

LOCATION AND COMMENTS: Corner is located at an old railroad tie fence corner with a fence running West, and field lines running North-South and East. A power pole line runs North and South through the corner monument.

OREGON STATE PLANE COORDINATE, North Zone, NAD 83(91), International Feet:

N = 757233.44  
E = 8586213.87

FIRM: William R. Wells, PLS  
P.O. Box 1696  
Pendleton, OR 97801

COMPASS DECLINATION: 18° East

Surveyor's Seal

Witnesses: Jason Wells, LSIT

/3N31N1

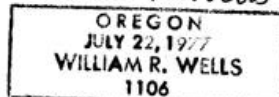
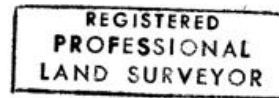

renews 6-30-08

06-462-C