

OREGON CORNER RECORPORATION FORM

Section 15 Township 3N Range 30E
 County Umatilla Date: July 11, 2007

Corner Designation: 3N30L13

Condition Report Only
 Not found

Quarter corner to sections 15 and 16, T3N, R30E, W.M.
 Umatilla County, Oregon.

 x Remonumented
 Unrecorded
 Surveyed in
 x Referenced out

Previous Renewals / Surveys, etc.

The corner was originally set by William B. Campbell under contract No. 95 dated September 19, 1860. His record reads: Set a post for quarter Section corner, drove a charred stake & raised mound of earth with trench and pits as per instructions.

Monument and Accessories found: (condition and source)

None. The position falls at the intersection of County roads North, South, and East.

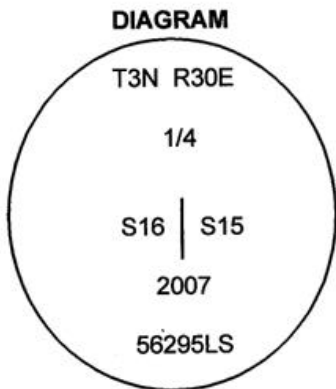

⊙ = Brass Cap
 • = Rebar Reference

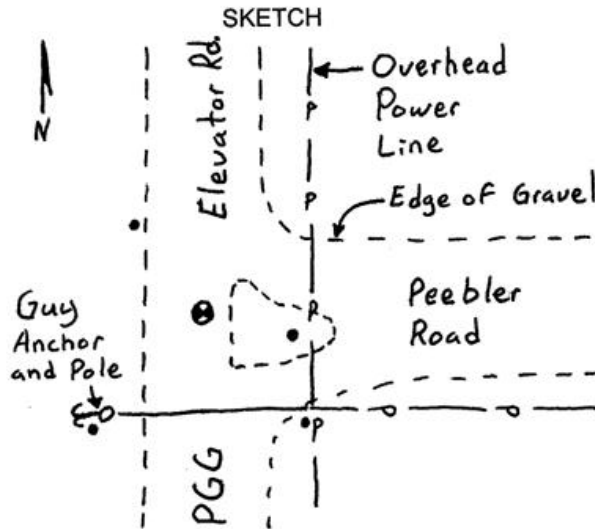

MONUMENT (S) AND ACCESSORIES SET (Procedures and Description)

I set a 2 1/4" brass cap on a 1 1/2" x 30" galvanized steel pipe at the intersection of the County road centerlines. The cap was stamped as shown in the diagram above. The top of the cap is approximately 6 inches below the surface of the road.

For references I set four 5/8" x 24" iron rebars with 1 1/8" orange plastic caps stamped WTS and 56295LS as described below:

- an iron rebar bears N21°00'24"W, 29.55 feet;
- an iron rebar bears S88°59'51"E, 25.05 feet;
- an iron rebar bears S41°07'11"E, 38.72 feet;
- an iron rebar bears S30°12'06"W, 36.35 feet;

The monument and references were tied using a Trimble R7/R8 RTK GPS

Location and comments

Compass Declination

Surveyors Seal

RECEIVED BY:
Umatilla County Surveyor
 Date: 8-07
 Rec'd By: KK
 No. 07-243-R

Firm / Agency
 Witness Tree Surveying
 Address
 P.O. Box G
 Pilot Rock, Or. 97868
 Party Chief
 Stephen K, Haddock

REGISTERED
 PROFESSIONAL
 LAND SURVEYOR

Stephen K. Haddock

OREGON
 JULY 9, 2001
 STEPHEN K. HADDOCK
 56295LS

RENEWAL DATE 6-30-09